

REV	DATE	CHANGE DESCRIPTION	MOD. BY	CK1	CK2
E	01/31/2005	CHANGED TO BOLTED INSERTS.	ZS	RJH	HM

PN 123008-D02
 SAE #3 HOUSING MOUNT
 (12) 27/64 DRILL THRU
 EQUALLY SPACED ON 16.88 B.C.
 SAE "B" PUMP MOUNT 4" DIA PUMP PILOT
 (2) 1/2-13 TAPPED HOLES
 EQ. SPACED ON 5.75 B.C.

123243-18
 12.374 O.D.
 (8) .406 HOLES
 ON 11.625 B.C.

123044-10
 SPLINE DATA
 15 TEETH
 16/32 D.P.
 30° P.A.
 1.016 MAJOR
 SAE "B-B"

PUMP
 OR
 MOTOR

1.81 SHAFT LENGTH

2.125
 BACKSET

SAE #3 HOUSING

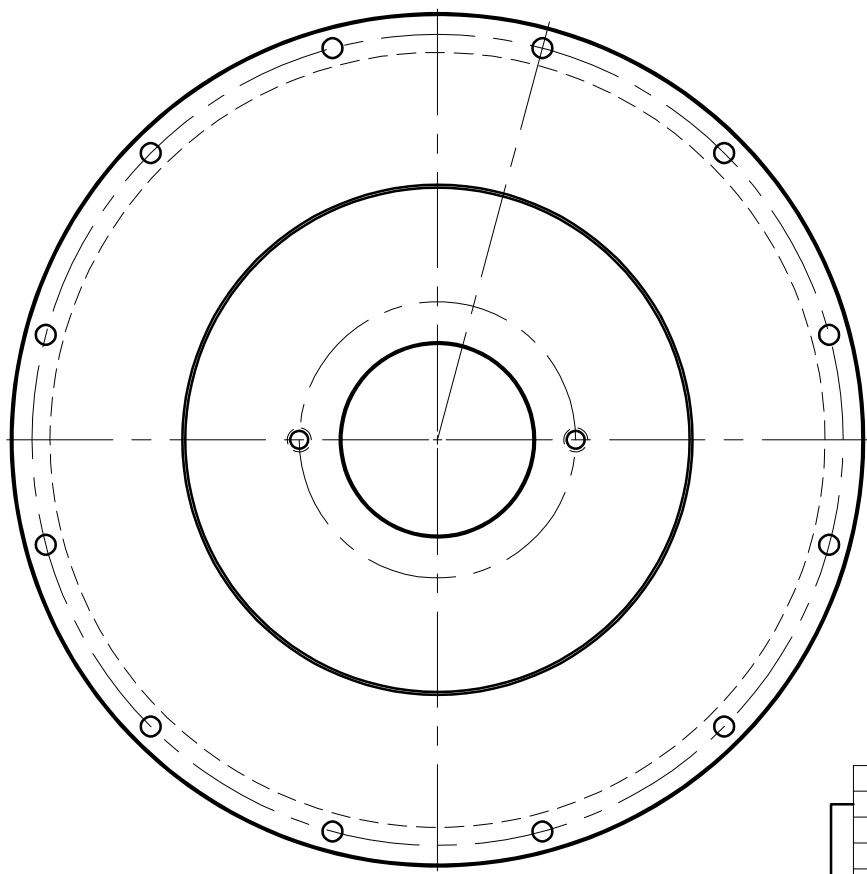

COUPLING ASS'Y #123263

UP TO 110 HP

QTY.	DESCRIPTION	PART NUMBER
1	FLYWHEEL PLATE	123008-D02
1	GREASE	801912
1	HUBBARD PLUG	HP-1125-S-32
6	THREADED BUSHING	123727
6	NEOPRENE INSERT	H62500
1	COUPLING HUB	123044-10
1	FLYWHEEL PLATE	123243-18

SYMBOLS	DET.	PART NUMBER	DESCRIPTION	QTY.
▭ FLATNESS — STRAIGHTNESS ∠ ANGULARITY ⊥ PERPENDICULARITY ∥ PARALLELISM ⊙ CONCENTRICITY ⊕ TRUE POSITION ○ ROUNDNESS Ⓢ CIRCULAR RUN OUT Ⓣ TOTAL RUN OUT Ⓜ CYLINDRICITY ✓ FINISH	DO NOT SCALE DRAWING TOLERANCES UNLESS OTHERWISE SPECIFIED 125 MAXIMUM ANGLE ±1/2° FRACTION ±1/32 DECIMAL .00 ±.01 .000 ±.005 .0000 ±.0005			
CLASS SAE 10	MAKE: <input checked="" type="checkbox"/> BUY: <input type="checkbox"/>	DRAWN BY SIETING	DATE 06-20-89	DRAWING NO. 123274
DESCRIPTION 10,3,15T16/32,B2,110	CHECKED BY RJH	SCALE	SHEET OF REV.	TITLE FLYWHEEL COUPLING ASS'Y WITH PUMP MOUNT PLATE

THIS DRAWING IS THE PROPERTY OF HAYES MFG. INC. AND IS LOANED SUBJECT TO THE CONDITION THAT IT SHALL NOT BE REPRODUCED, COPIED, LOANED OR OTHERWISE DISPOSED OF, DIRECTLY OR INDIRECTLY. IT SHALL BE USED AS A MEANS OF REFERENCE TO WORK FURNISHED BY THIS COMPANY ONLY AND IS NOT TO BE SUBMITTED TO OUTSIDE PARTIES FOR EXAMINATION WITHOUT OUR CONSENT.