

REV	DATE	CHANGE DESCRIPTION	MOD. BY	CK1	CK2
A	09/23/2002	REMOVED BACKING PLATE.	ZS	RJH	HM

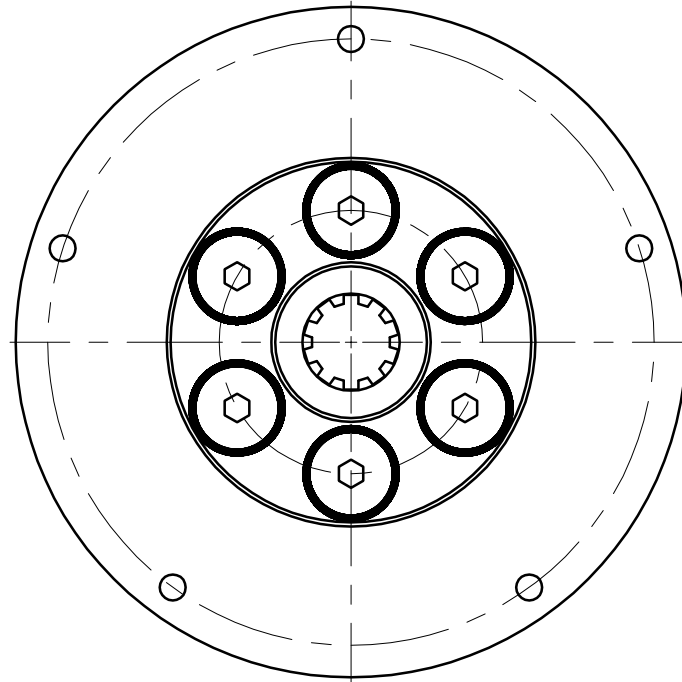
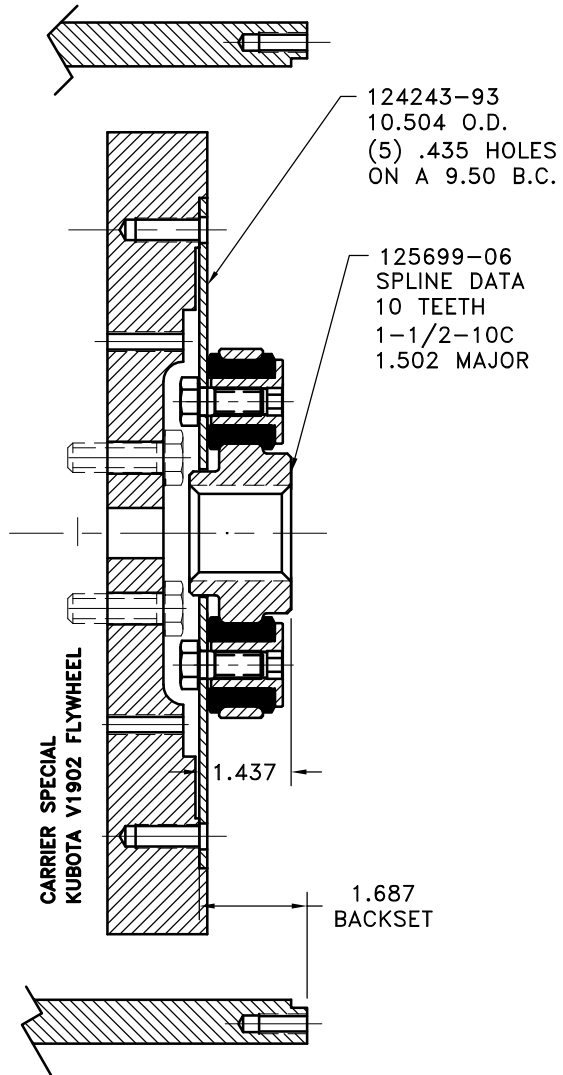

UP TO 110 HP.

QTY.	DESCRIPTION	PART NUMBER
1	FLYWHEEL PLATE	124243-93
1	COUPLING HUB	125699-06
6	NEOPRENE INSERT	H92500
6	THREADED BUSHING	124412
6	7/16-20 x 1" HHB	HX200
1	GREASE	801912

SYMBOLS		DET.	PART NUMBER	DESCRIPTION	QTY.
	FLATNESS				
	STRAIGHTNESS				
	ANGULARITY				
	SQUARENESS				
	PARALLELISM				
	CONCENTRICITY				
	TRUE POSITION				
	ROUNDNESS				
	CIRCULAR RUN OUT				
	TOTAL RUN OUT				
	CYLINDRICITY				
	FINISH				
- UNLESS OTHERWISE SPECIFIED - REMOVE FIRST THREAD ON ALL TAPPED HOLES BREAK ALL SHARP CORNERS .010 TO .020 STAMP OR MARK DRAWING NO.		DO NOT SCALE DRAWING TOLERANCES UNLESS OTHERWISE SPECIFIED 1/32" MAXIMUM ANGLE ±1/2° FRACTION ±1/32 DECIMAL .00 ±.01 .000 ±.005 .0000 ±.0005		 TITLE FLYWHEEL COUPLING ASS'Y MATERIAL	
DRAWN BY SIETING		DATE 7-23-02		DRAWING NO. 126847	
CHECKED BY RJH		SCALE		SHEET OF REV.	

THIS DRAWING IS THE PROPERTY OF HAYES MFG. INC. AND IS LOANED SUBJECT TO THE CONDITION THAT IT SHALL NOT BE REPRODUCED, COPIED, LOANED OR OTHERWISE DISPOSED OF, DIRECTLY OR INDIRECTLY. IT SHALL BE USED AS A MEANS OF REFERENCE TO WORK FURNISHED BY THIS COMPANY ONLY AND IS NOT TO BE SUBMITTED TO OUTSIDE PARTIES FOR EXAMINATION WITHOUT OUR CONSENT.