

| REV | DATE | CHANGE DESCRIPTION | MOD.BY | CK1 | CK2 |
|-----|------|--------------------|--------|-----|-----|
| | | | | | |

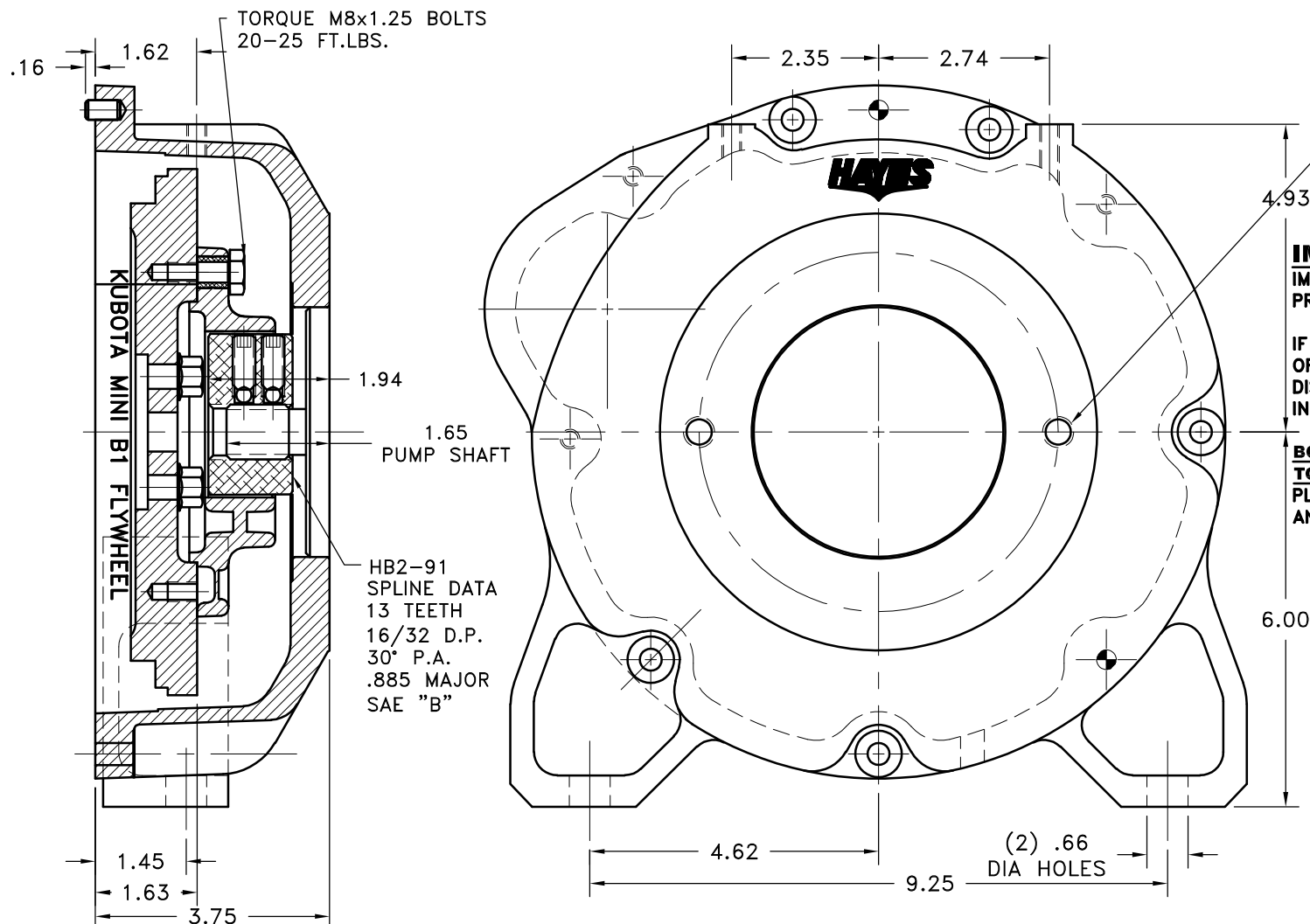

SAE "B" 2-BOLT MOUNT
4.00 DIA PUMP PILOT
(2) 1/2-13 TAPPED HOLES
EQ. SPACED ON 5.75 B.C.

IMPORTANT INSTALLATION NOTE!!!!
IMPROPER INSTALLATION OF HUB COULD CAUSE
PREMATURE WEAR AND OR FAILURE.

IF YOU HAVE QUESTIONS CONCERNING LOCATION
OF METAL HUB ON PUMP SHAFT PLEASE CONTACT
DISTRIBUTOR OR FACTORY FOR FURTHER
INFORMATION

**BOTH HUB SET SCREWS MUST BE PROPERLY
TORQUED TO 25 FT.LBS. USING TORQUE WRENCH.**
PLEASE CONTACT DISTRIBUTOR OR FACTORY FOR
ANY FURTHER QUESTIONS.

NOTES:

1. HOUSING FOR KUBOTA ENGINES
Z442-B, Z482-B, D662-B,
D722-B, WG600-B, G750-B

ASS'Y WORKS WITH
FLYWHEELS: C-1(16851-25118)
& C-2(16861-25112)
STARTER PLATE:
E-2(19666-04621)

NOTE: THIS STEP IS IMPORTANT TO ENSURE FULL SPLINE ENGAGEMENT.

- 1) PRESET HUB ON SHAFT AS SHOWN.
- 2) IF YOUR PUMP SHAFT VARIES FROM THE DRAWN
SHAFT LENGTH, CONTACT FACTORY FOR
RECOMMENDATIONS.
- 3) **TORQUE BOTH SET SCREWS TO 25 FT.LBS. USING
TORQUE WRENCH.**
- 4) SHAFT SHOULD HAVE FULL SPLINE ENGAGEMENT INTO
HUB, IF NOT CONTACT FACTORY FOR
RECOMMENDATIONS (231) 879-3372.

THIS DRAWING IS THE PROPERTY OF HAYES MFG. INC. AND IS LOANED
SUBJECT TO THE CONDITION THAT IT SHALL NOT BE REPRODUCED,
COPIED, LOANED OR OTHERWISE DISPOSED OF, DIRECTLY OR INDIRECTLY.
IT SHALL BE USED AS A MEANS OF REFERENCE TO WORK FURNISHED BY
THIS COMPANY ONLY AND IS NOT TO BE SUBMITTED TO OUTSIDE PARTIES
FOR EXAMINATION WITHOUT OUR CONSENT.

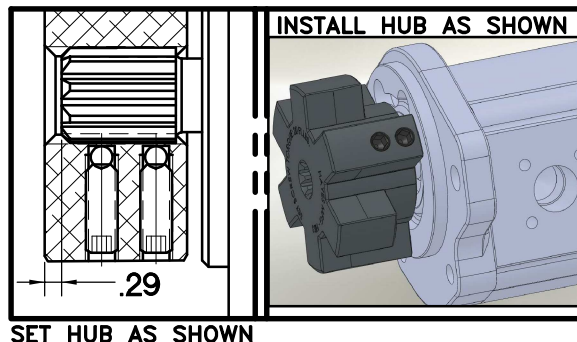

SET HUB AS SHOWN

| | | | |
|---|----------------|-------------------------|---|
| 5 | 930114-02 | HOUSING | 1 |
| 4 | 930112 | BOLT KIT | 1 |
| 3 | SD200X5/16X1/2 | 5/16 X 1/2 SPRING DOWEL | 2 |
| 2 | HB2-91 | HEX~FLX HUB | 1 |
| 1 | B-SMN | HEX~FLX FLYWHEEL PLATE | 1 |

| SYMBOLS | DET. | PART NUMBER | DESCRIPTION | QTY. |
|---|--|---|---|------|
| FLATNESS STRAIGHTNESS ANGULARITY PERPENDICULARITY PARALLELISM CONCENTRICITY TRUE POSITION ROUNDNESS CIRCULAR RUN OUT TOTAL RUN OUT CYLINDRICITY FINISH | DO NOT SCALE DRAWING TOLERANCES UNLESS OTHERWISE SPECIFIED 125 MAXIMUM ANGLE ±1/2° FRACTION ±1/32 DECIMAL .00 ±.01 .000 ±.005 .0000 ±.0005 | MAKE: <input checked="" type="checkbox"/> BUY: <input type="checkbox"/> | HAYES MANUFACTURING INC. ® TITLE KUBOTA MINI HEX-FLX COUPLING ASS'Y MATERIAL | |
| CLASS KUBOTA DESCRIPTION KBMNF1,13T16/32,B2 | DRAWN BY LAWSON CHECKED BY | DATE 2-24-2015 SCALE | DRAWING NO. 001-0-HB2-91-B2 SHEET OF REV. | |