

REV	DATE	CHANGE DESCRIPTION	MOD.BY	CK1	CK2

CUSTOMER TO
SUPPLY STARTER
PLATE

P/N 942000-xx
S.A.E. "B" PUMP MOUNT
3.25" PILOT, (2) HOLES
EQ. SPACED ON A 4.19 B.C.

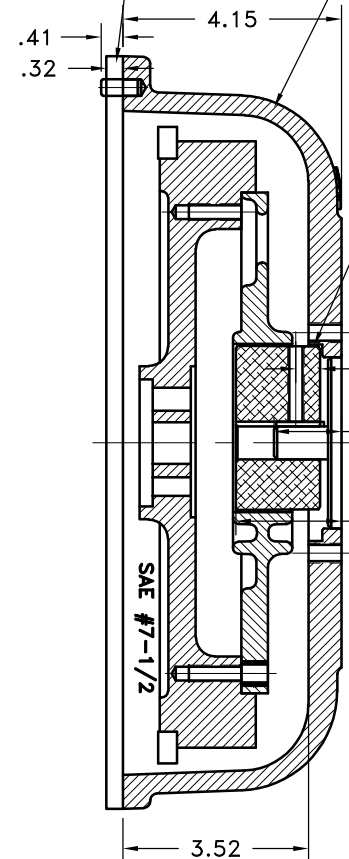

HC2-05
5/8" SHAFT
3/16" KEY

SEE BOX TO
POSITION HUB
NOT TO SCALE

2.00 INSTALLED
HUB LENGTH

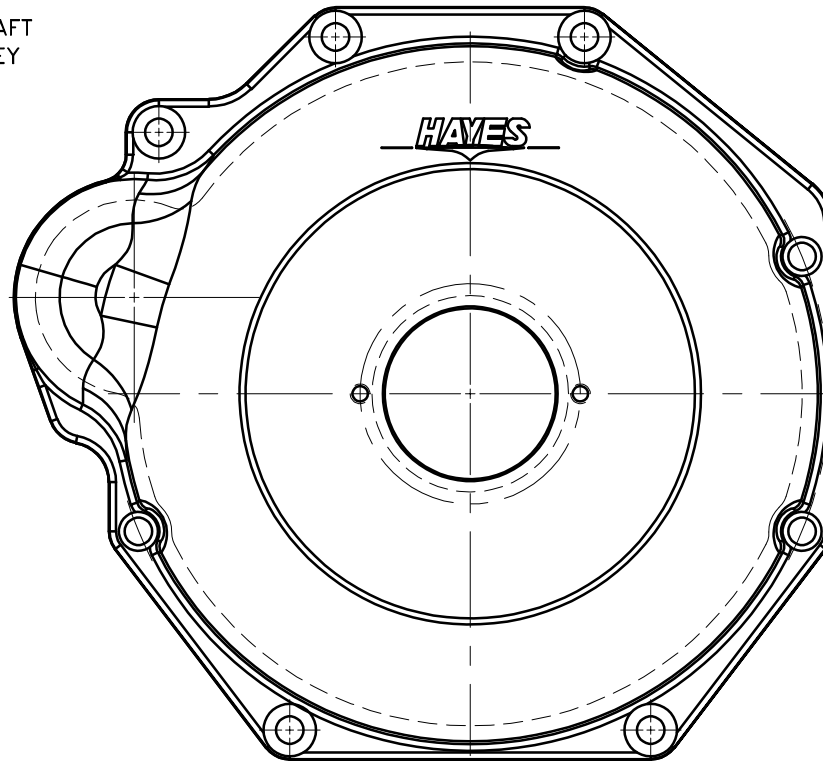

FITS YANMAR ENGINES:
3TNE-78A, 82A, 84, 88, 84(T),
88

FITS ISUZU ENGINES:
3CD1

IMPORTANT INSTALLATION NOTE!!!!
IMPROPER INSTALLATION OF HUB COULD CAUSE
PREMATURE WEAR AND OR FAILURE.

IF YOU HAVE QUESTIONS CONCERNING LOCATION
OF METAL HUB ON PUMP SHAFT PLEASE CONTACT
DISTRIBUTOR OR FACTORY FOR FURTHER
INFORMATION

**BOTH HUB SET SCREWS MUST BE PROPERLY
TORQUED TO 25 FT.LBS. USING TORQUE WRENCH.**
PLEASE CONTACT DISTRIBUTOR OR FACTORY FOR
ANY FURTHER QUESTIONS.

NOTE: REMOVE HUB FROM ASS'Y, PRESET HUB ON SHAFT
& REASSEMBLE USING NUT & BOLT GRADE LOC-TITE ON
SET SCREWS. TORQUE SET SCREWS TO 25 FT.LBS. SHAFT
SHOULD HAVE A MINIMUM OF 3/4" OF ENGAGEMENT IF
NOT CONTACT FACTORY FOR RECOMMENDATIONS. TO GET
HUB PRESET USE THIS EQUATION:

EXAMPLE:
2.00 - SHAFT LENGTH = HUB PRESET

IF YOUR ANSWER IS (+) SHAFT IS INSIDE OF HUB, IF
YOUR ANSWER IS (-) SHAFT STICKS OUT OF HUB.
(SEE BOXES)

NOTE: THIS STEP IS IMPORTANT TO
ENSURE FULL SPLINE ENGAGEMENT.

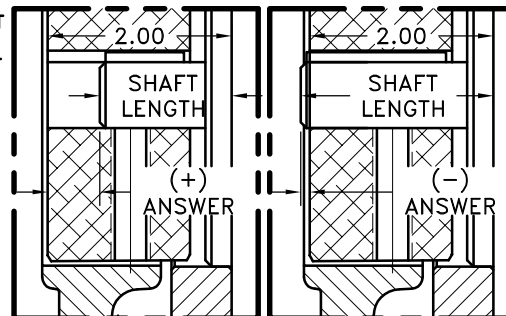

THIS DRAWING IS THE PROPERTY OF HAYES MFG. INC. AND IS LOANED
SUBJECT TO THE CONDITION THAT IT SHALL NOT BE REPRODUCED,
COPIED, LOANED OR OTHERWISE DISPOSED OF, DIRECTLY OR INDIRECTLY.
IT SHALL BE USED AS A MEANS OF REFERENCE TO WORK FURNISHED BY
THIS COMPANY ONLY AND IS NOT TO BE SUBMITTED TO OUTSIDE PARTIES
FOR EXAMINATION WITHOUT OUR CONSENT.

UP TO 50 HP

5	SD200X5/16X3/4	5/16x3/4 SPRING DOWEL	2
4	942026	BOLT KIT	1
3	942000-XX	HOUSING	1
2	HC2-05	HEX~FLX HUB	1
1	C-075	HEX~FLX DRIVE PLATE	1

SYMBOLS	DET.	PART NUMBER	DESCRIPTION	QTY.
DO NOT SCALE DRAWING TOLERANCES UNLESS OTHERWISE SPECIFIED 125 MAXIMUM ANGLE ±1/2" FRACTION ±1/32 DECIMAL .00 ±.01 .000 ±.005 .0000 ±.0005 FINISH				
CLASS YANMAR DESCRIPTION YNM3TN,5/8X3/16,A2	MAKE: <input checked="" type="checkbox"/> BUY: <input type="checkbox"/>	DRAWN BY SIETING CHECKED BY SCALE	DATE 03-29-2016 DRAWING NO. 037-0-HC2-05-A2 SHEET OF REV.	

HAYES
MANUFACTURING INC. ®

TITLE
YANMAR HEX~FLX COUPLING WITH HOUSING

MATERIAL