

REV	DATE	CHANGE DESCRIPTION	MOD. BY	CK1	CK2

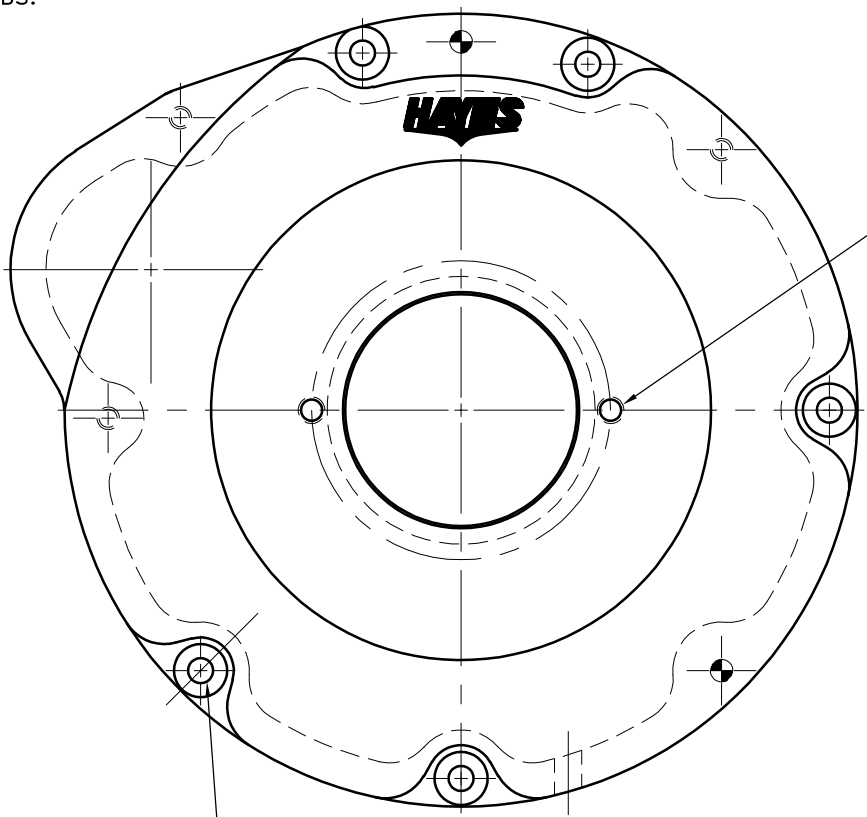
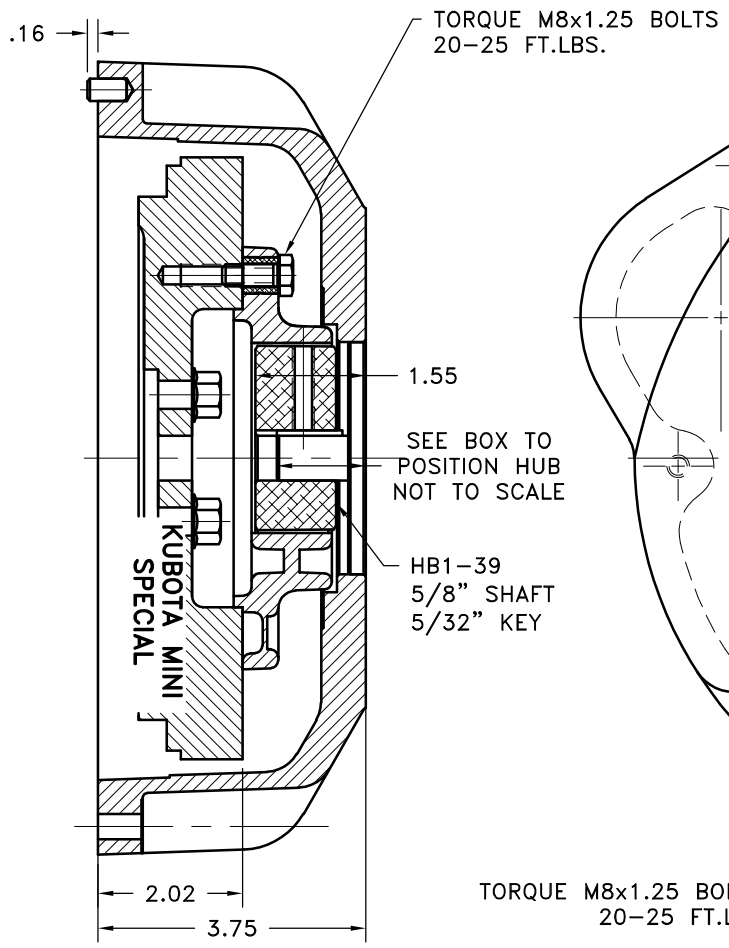

NOTES: SPECIAL FOR D902

1. HOUSING FOR KUBOTA ENGINES D902

IMPORTANT INSTALLATION NOTE!!!!
 IMPROPER INSTALLATION OF HUB COULD CAUSE PREMATURE WEAR AND OR FAILURE.

IF YOU HAVE QUESTIONS CONCERNING LOCATION OF METAL HUB ON PUMP SHAFT PLEASE CONTACT DISTRIBUTOR OR FACTORY FOR FURTHER INFORMATION

BOTH HUB SET SCREWS MUST BE PROPERLY TORQUED TO 25 FT.LBS. USING TORQUE WRENCH.
 PLEASE CONTACT DISTRIBUTOR OR FACTORY FOR ANY FURTHER QUESTIONS.

NOTE: REMOVE HUB FROM ASS'Y, PRESET HUB ON SHAFT AS SHOWN. **TORQUE BOTH SET SCREWS TO 25 FT.LBS. USING TORQUE WRENCH.** SHAFT SHOULD HAVE A MINIMUM OF 3/4" OF ENGAGEMENT IF NOT CONTACT FACTORY FOR RECOMMENDATIONS (231) 879-3372 TO GET HUB PRESET USE THIS EQUATION:

PERFORM CALCULATION BELOW:
1.55 - SHAFT LENGTH - HUB PRESET

IF YOUR ANSWER IS (+) SHAFT IS INSIDE OF HUB, IF YOUR ANSWER IS (-) SHAFT STICKS OUT OF HUB. (SEE BOXES)

NOTE: THIS STEP IS IMPORTANT TO ENSURE FULL SHAFT ENGAGEMENT.

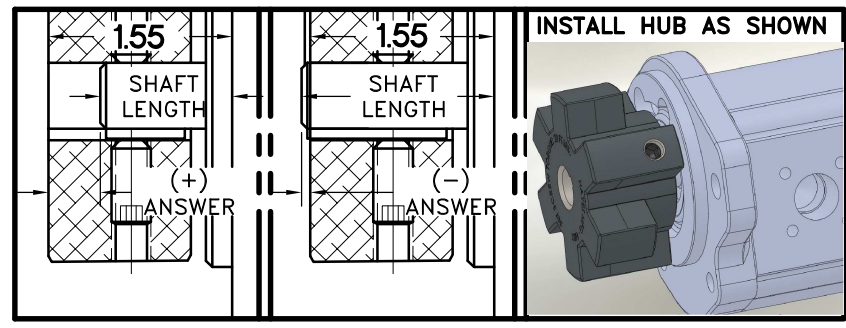

QTY.	DESCRIPTION	PART NUMBER	DET.
1	HOUSING	930100-13	5
1	BOLT KIT (PRE-ASSEMBLED)	930112	4
2	5/16 X 1/2 SPRING DOWEL	SD200X5/16X1/2	3
1	HEX~FLX HUB	HB1-39	2
1	HEX~FLX FLYWHEEL PLATE	B-SMN	1

SYMBOLS		DET.		PART NUMBER		DESCRIPTION		QTY.
	FLATNESS	DO NOT SCALE	DRAWING					
	STRAIGHTNESS	TOLERANCES UNLESS OTHERWISE SPECIFIED						
	ANGULARITY	125	MAXIMUM					
	PERPENDICULARITY	ANGLE ±1/2°						
	PARALLELISM	FRACTION ±1/32	DECIMAL					
	CONCENTRICITY	.00 ±.01						
	TRUE POSITION	.000 ±.005						
	CIRCULAR RUN OUT	.0000 ±.0005						
	TOTAL RUN OUT							
	CYLINDRICITY							
	FINISH							
CLASS		MAKE: <input checked="" type="checkbox"/>	BUY: <input type="checkbox"/>	DRAWN BY		DATE		DRAWING NO.
DESCRIPTION		KB902		KNH		05-02-2013		044-0-HB1-39-A2
DESCRIPTION		KB902,5/8x5/32,A2		CHECKED BY		SCALE		SHEET OF REV.
				RJH				1 OF 1