

REV	DATE	CHANGE DESCRIPTION	MOD.BY	CK1	CK2
E	11/22/2004	CHANGED TO BOLTED INSERTS.	ZS	RJH	HM

PT# 123401-3A  
SAE 3 HOUSING MOUNT  
(12) 27/64 HOLES EQUALLY SPACED ON 16.88" B.C.  
6.30" PUMP PILOT SAE "SPECIAL" PUMP MOUNT.  
(2) 5/8-11 TAPPED HOLES EQUALLY  
SPACED ON 8.819" B.C. FOR PUMP MOUNT.

123243-13  
10.375 O.D.  
(6) .406 HOLES  
ON 9.625 B.C.

123713-24  
SPLINE DATA:  
21 TEETH  
W45x2x30x21x9H  
DIN 5480  
1.790 MAJOR

PUMP  
OR  
MOTOR

1.96

SAE 8  
FLYWHEEL

2.16

2.44  
BACKSET

SAE #3 HOUSING

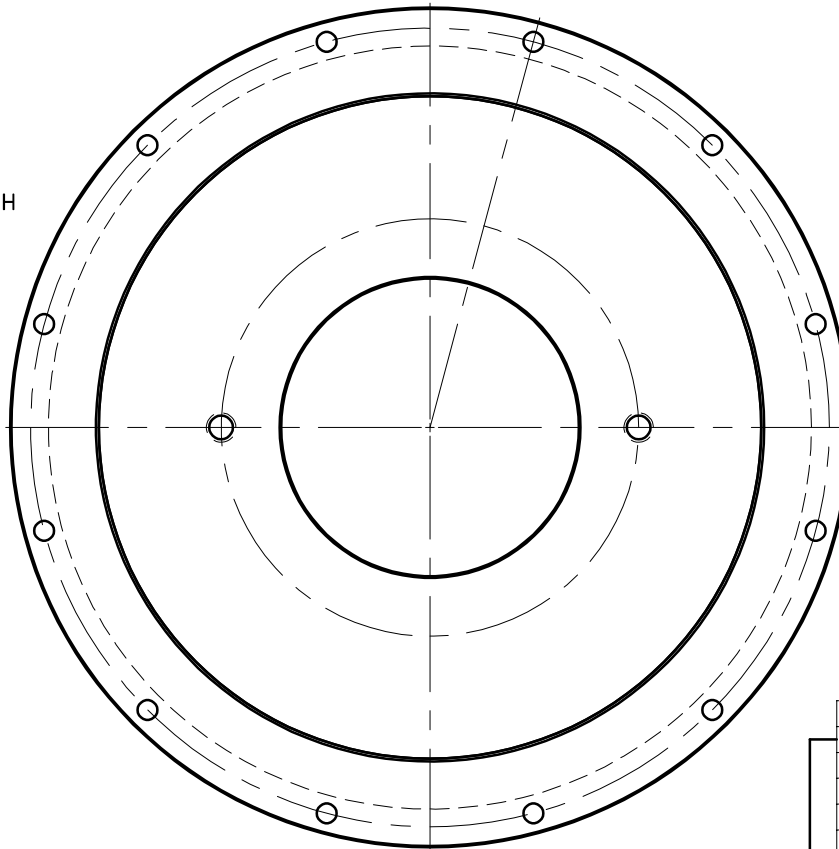

COUPLING ASS'Y #123063

UP TO 150 HP.

10	123401-3A	PUMP MOUNT PLATE [3]	1
9	801912	GREASE	1
8	HP-2000-S-62	HUBBARD PLUG	1
7	NUT	7/16-20 NUT	8
6	BOLT	7/16-20 x 1 3/4" HHB	8
5	123000-00	STEEL BUSHING	8
4	H62500	NEOPRENE INSERT	8
3	123713-24	COUP HUB [W45x2x30x21x9H\5.000]	1
2	124657-02	BACKING PLATE	1
1	123243-13	FLYWHEEL PLATE [8\5.000]	1

SYMBOLS	DET.	PART NUMBER	DESCRIPTION	QTY.
FLATNESS STRAIGHTNESS ANGULARITY PERPENDICULARITY PARALLELISM CONCENTRICITY TRUE POSITION ROUNDNESS CIRCULAR RUN OUT TOTAL RUN OUT CYLINDRICITY FINISH	DO NOT SCALE DRAWING TOLERANCES UNLESS OTHERWISE SPECIFIED 125 MAXIMUM ANGLE $\pm 1/2^\circ$ FRACTION $\pm 1/32$ DECIMAL .00 $\pm$ .01 .000 $\pm$ .005 .0000 $\pm$ .0005	MAKE: <input checked="" type="checkbox"/> BUY: <input type="checkbox"/>	<b>HAYES</b> MANUFACTURING INC. ® TITLE FLYWHEEL COUPLING ASS'Y WITH PUMP MOUNT PLATE MATERIAL	
CLASS	DESCRIPTION	DRAWN BY	DATE	DRAWING NO.
	8,3,21TW45x2x30x21x9H,150	SIETING	09-14-89	123415
		CHECKED BY	SCALE	SHEET OF REV.
		RJH		

THIS DRAWING IS THE PROPERTY OF HAYES MFG. INC. AND IS LOANED  
SUBJECT TO THE CONDITION THAT IT SHALL NOT BE REPRODUCED,  
COPIED, LOANED OR OTHERWISE DISPOSED OF, DIRECTLY OR INDIRECTLY.  
IT SHALL BE USED AS A MEANS OF REFERENCE TO WORK FURNISHED BY  
THIS COMPANY ONLY AND IS NOT TO BE SUBMITTED TO OUTSIDE PARTIES  
FOR EXAMINATION WITHOUT OUR CONSENT.