

CUSTOMER DRAWING

REVISIONS						
ZONE	REV.	DESCRIPTION	DATE	APR 1	APR 2	DCR #
3-B2, 4-B2	C	CHANGED TO PILOTED BUSHINGS	4/29/2024	ZS	HM	4249

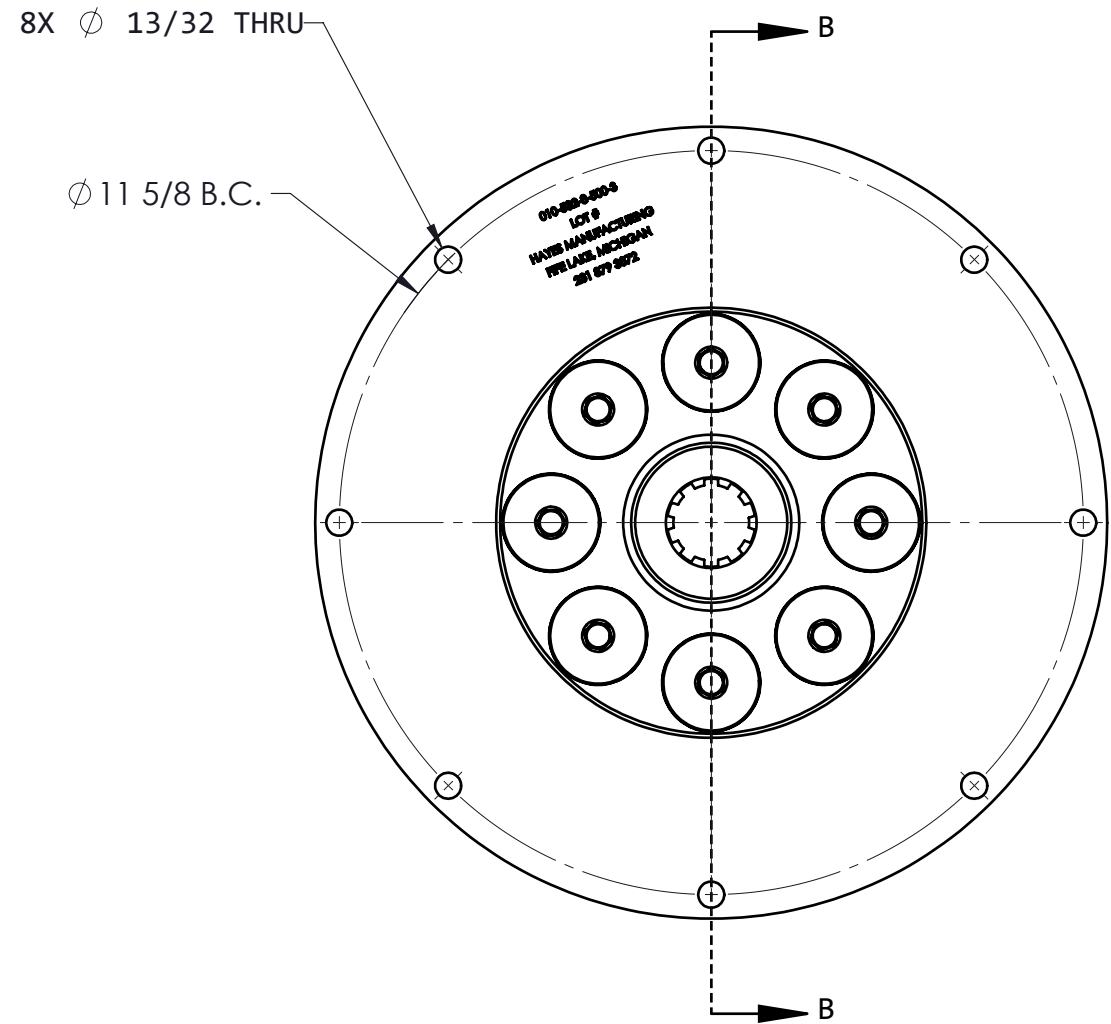
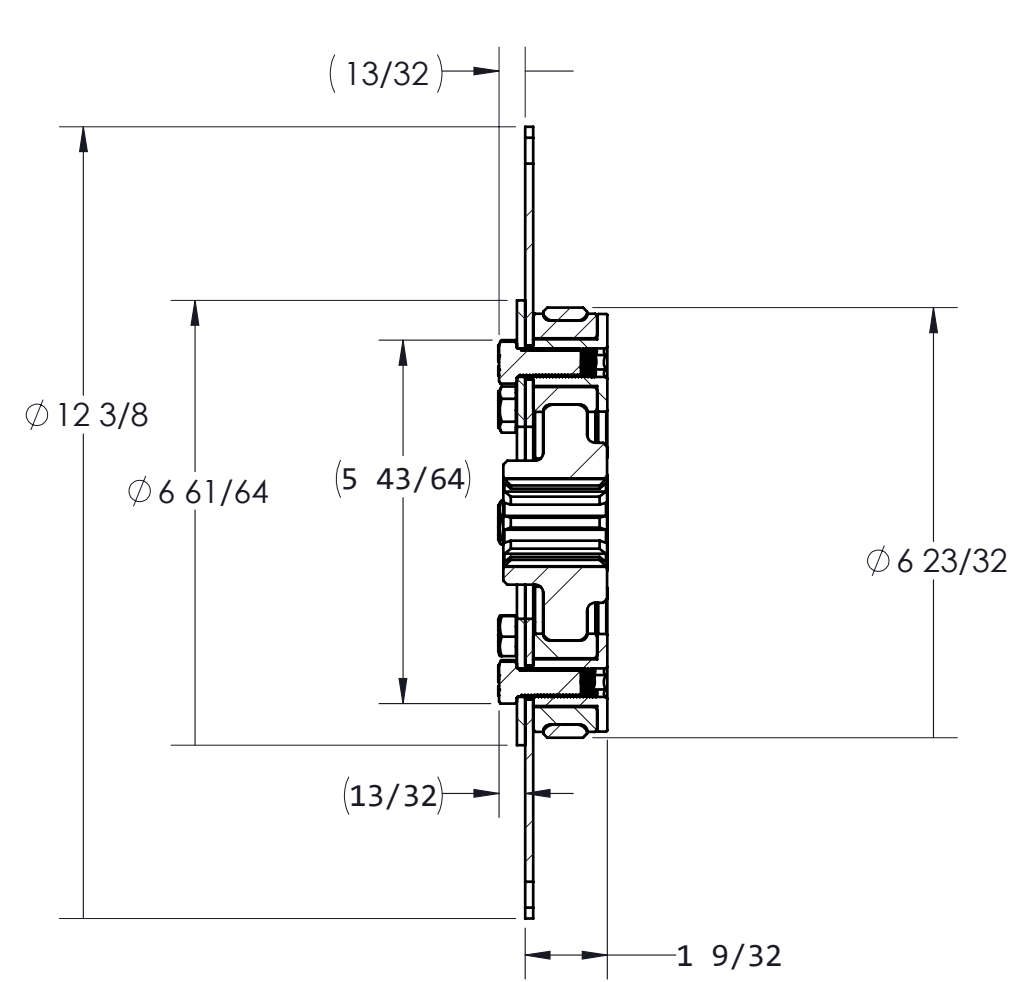

COUPLING IS NOT SERVICEABLE

PUMP DRIVE SPECS	
FLYWHEEL	SAE 10
PUMP SHAFT	1-3/8-10
HP RATING (@1800 RPM)	150

UNLESS OTHERWISE SPECIFIED:
DIMENSIONS ARE IN INCHES
TOLERANCES:
FRACTIONAL $\pm 1/32$
ANGULAR: MACH $\pm 1/2^\circ$
TWO DECIMAL $\pm .01$
THREE DECIMAL $\pm .005$
FOUR DECIMAL $\pm .0005$

PROPRIETARY AND CONFIDENTIAL
THE INFORMATION CONTAINED IN THIS DRAWING IS THE SOLE PROPERTY OF HAYES MANUFACTURING. ANY REPRODUCTION IN PART OR AS A WHOLE WITHOUT THE WRITTEN PERMISSION OF HAYES MANUFACTURING IS PROHIBITED.

CLASS
SAE 10

DESCRIPTION
10, 1-3/8-10, 150

MAKE X	WEIGHT 12.3 LB	HEAT TREAT
BUY	VOLUME CU. IN.	FINISH

SYMBOLS

\square FLATNESS	\odot CONCENTRICITY	\sqcup COUNTERBORE
\bigcirc ROUNDNESS	\oplus TRUE POSITION	∇ COUNTERSINK
\parallel PARALLELISM	\perp PERPENDICULARITY	\equiv SYMMETRIC
ϕ DIAMETER	\nearrow CIRCULAR RUN OUT	
"R" RADIUS	\nearrow TOTAL RUN OUT	

DRAWN	NAME VHA	DATE 4/14/2024
PCM APPR.	HM	5/14/2024
ENG APPR.	ZS	5/1/2024
SHIP. APPR.		
QA APPR.		
MATERIAL		

TITLE:
FLYWHEEL COUPLING ASSEMBLY

DWG. NO.
125785

REV
C

DO NOT SCALE

SHEET 1 OF 4

