

5 4 3 2 1

CUSTOMER DRAWING

REV.	DESCRIPTION	DATE	APR 1	APR 2
A	RELEASED IN SOLIDWORKS	4/27/2023		

D

C

B

A

12X ϕ 27/64 \pm 1/64 THRU

ϕ 15

123008-EN2
LOT #

6X ϕ 11/32 THRU

ϕ 7 7/8

COUPLING VIEW

2X ϕ 5/16 THRU
3/8-16 UNC THRU

ϕ 4 3/16

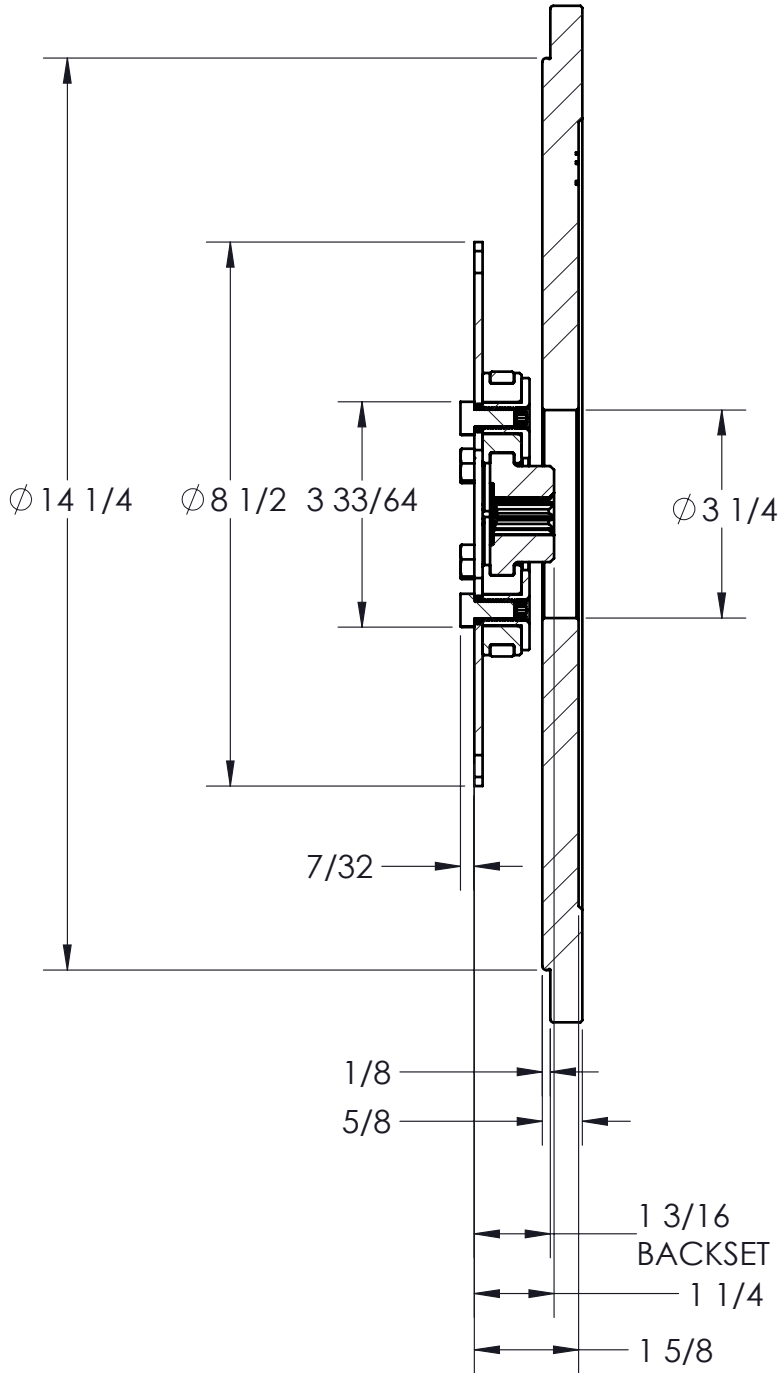

COUPLING IS NOT SERVICEABLE

ITEM NO.	PART NUMBER	DESCRIPTION	QTY.
1	123379	FLYWHEEL COUPLING ASSY	1
2	123008-EN2	PUMP MOUNT PLATE	1

UNLESS OTHERWISE SPECIFIED:
DIMENSIONS ARE IN INCHES
TOLERANCES:
FRACTIONAL \pm 1/32
ANGULAR: MACH \pm 1/2°
TWO DECIMAL \pm 0.01
THREE DECIMAL \pm 0.005
FOUR DECIMAL \pm 0.0005

SYMBOLS
□ FLATNESS ○ CONCENTRICITY ▭ COUNTERBORE
○ ROUNDNESS ⊕ TRUE POSITION ▽ COUNTERSINK
// PARALLELISM ⊥ PERPENDICULARITY = SYMMETRIC
∅ DIAMETER ↗ CIRCULAR RUN OUT
"R" RADIUS ↗ TOTAL RUN OUT

CLASS
SAE 6-1/2

DESCRIPTION
6-1/2,4,9T16/32,A2,50

MAKE	WEIGHT	HEAT TREAT
X	33.8 LB	
BUY	VOLUME	FINISH
	CU.IN.	

	NAME	DATE
DRAWN	PJH	5/4/2023
PCM APPR.		
ENG APPR.		
SHIP. APPR.		
QA APPR.		
MATERIAL		



TITLE:
PUMP DRIVE KIT

DWG. NO.
126256

REV
A

DO NOT SCALE

SHEET 1 OF 4

PROPRIETARY AND CONFIDENTIAL
THE INFORMATION CONTAINED IN THIS
DRAWING IS THE SOLE PROPERTY OF
HAYES MANUFACTURING. ANY
REPRODUCTION IN PART OR AS A WHOLE
WITHOUT THE WRITTEN PERMISSION OF
HAYES MANUFACTURING IS PROHIBITED.

PUMP DRIVE SPECS

FLYWHEEL	SAE 6.5
HOUSING	SAE 4
PUMP FLANGE	SAE A 2-BOLT
PUMP SHAFT	9T 16/32 "A"
HP RATING (@1800 RPM)	50

5 4 3 2 1