

REV	DATE	CHANGE DESCRIPTION	MOD.BY	CK1	CK2
A3	11/29/2006	ADDED NOTES TO ATTN BOX.	ZS	RJH	HM

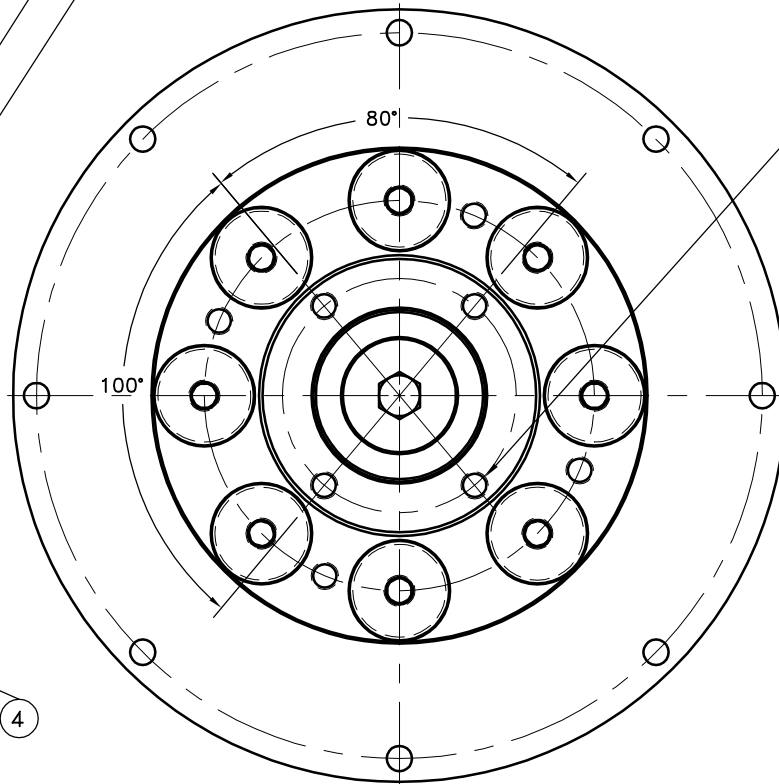
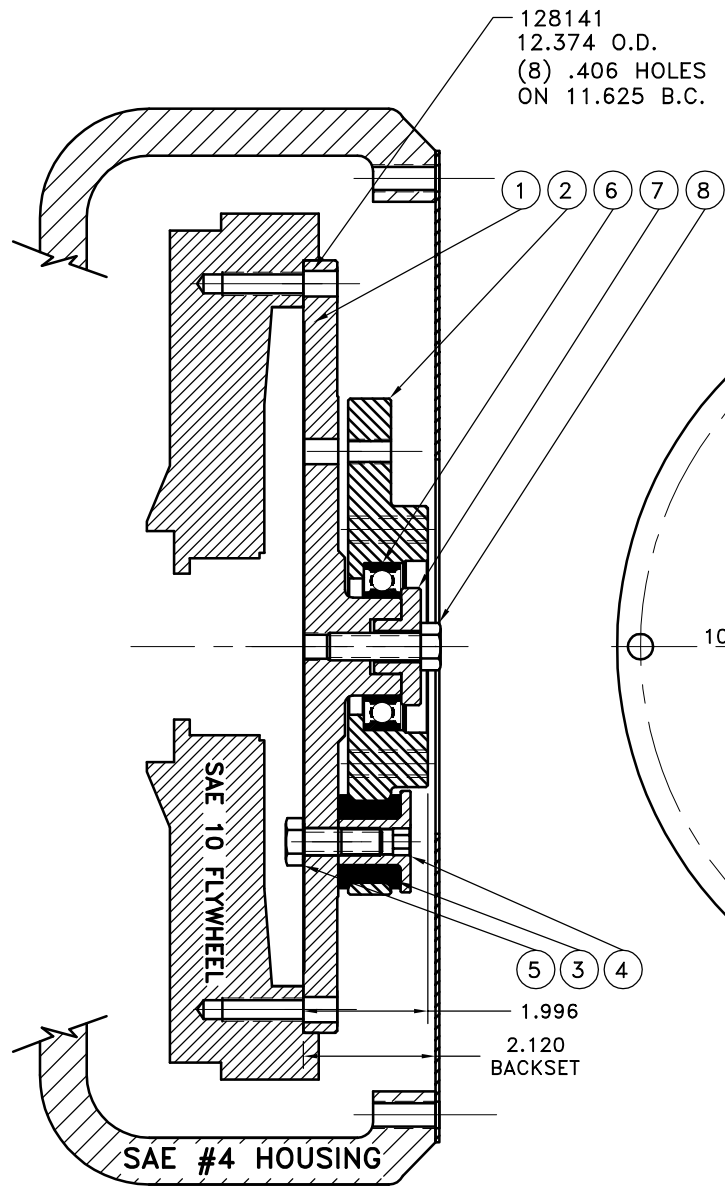

(4) 7/16-20 TAPPED HOLES
ON 3.75 [E] B.C.

UP TO 150 HP

9	128216	COVER PLATE	1
8	HX220	7/16-20 x 1 1/2" HHB	1
7	126988	BEARING RETAINER	1
6	60082RS	BEARING	1
5	PURCHASE	7/16-20 x 1 1/4" HHB	8
4	124412	THREADED BUSHING	8
3	H92500	NEOPRENE INSERT	8
2	125547	U-JOINT HUB	1
1	128141	FLYWHEEL PLATE	1

SYMBOLS	DET.	PART NUMBER	DESCRIPTION	QTY.
FLATNESS STRAIGHTNESS ANGULARITY SQUARENESS PARALLELISM CONCENTRICITY TRUE POSITION ROUNDNESS CIRCULAR RUN OUT TOTAL RUN OUT CYLINDRICITY FINISH	DO NOT SCALE DRAWING TOLERANCES UNLESS OTHERWISE SPECIFIED 125 MAXIMUM ANGLE ±1/2° FRACTION ±1/32 DECIMAL .00 ±.01 .000 ±.005 .0000 ±.0005		HAYES MANUFACTURING INC. ® TITLE U-JOINT COUPLING MATERIAL	
- UNLESS OTHERWISE SPECIFIED - REMOVE FIRST THREAD ON ALL TAPPED HOLES BREAK ALL SHARP CORNERS .010 TO .020 STAMP OR MARK DRAWING NO.	DRAWN BY SIETING CHECKED BY RJH	DATE 02-14-06 SCALE	DRAWING NO. 128140 SHEET OF REV.	

THIS DRAWING IS THE PROPERTY OF HAYES MFG. INC. AND IS LOANED
SUBJECT TO THE CONDITION THAT IT SHALL NOT BE REPRODUCED,
COPIED, LOANED OR OTHERWISE DISPOSED OF, DIRECTLY OR INDIRECTLY.
IT SHALL BE USED AS A MEANS OF REFERENCE TO WORK FURNISHED BY
THIS COMPANY ONLY AND IS NOT TO BE SUBMITTED TO OUTSIDE PARTIES
FOR EXAMINATION WITHOUT OUR CONSENT.