

REV	DATE	CHANGE DESCRIPTION	MOD BY	CK1	CK2

TORQUE M10 BOLTS  
29-33 FT.LBS.

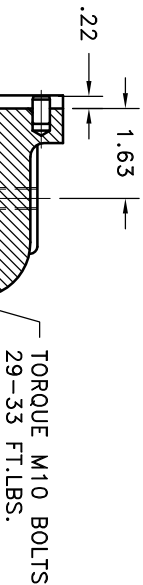

PUMP  
OR  
MOTOR

HB2-89  
SPLINE DATA  
15 TEETH  
16/32 D.P.  
30° P.A.  
1.016 MAJOR  
SAE "B-B"

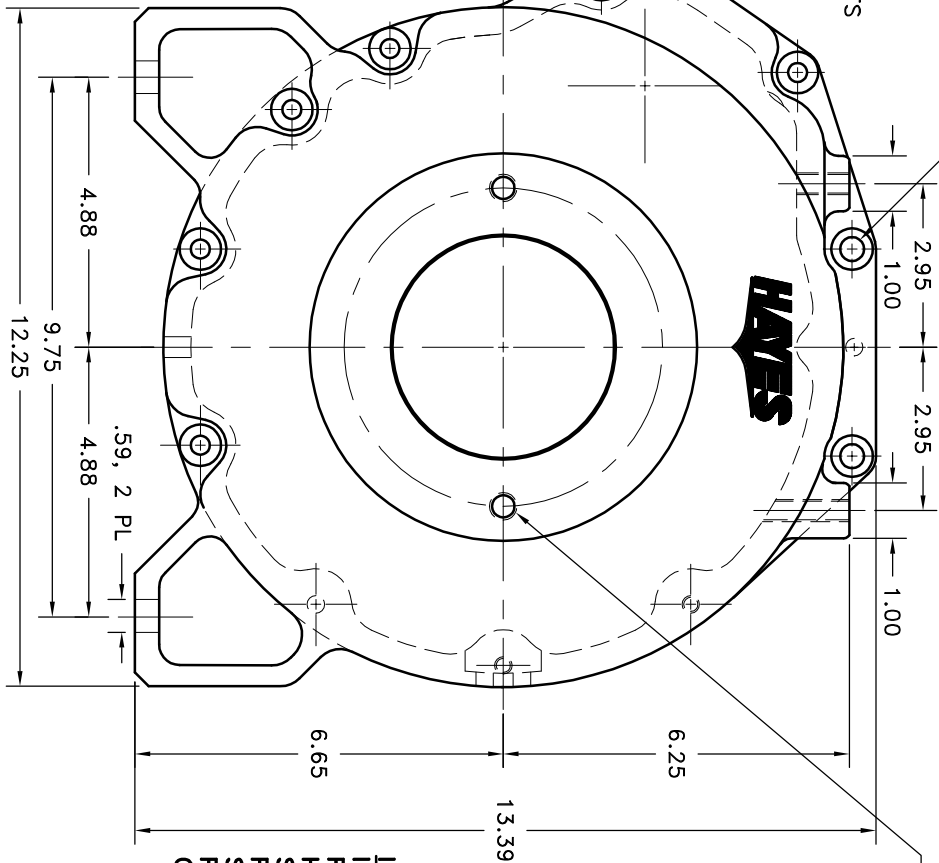
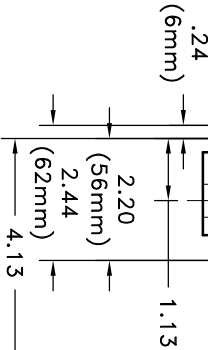

S.A.E. B 2-BOLT MOUNT  
4.00" PILOT  
(2) 1/2-13 TAPPED HOLES  
EQ. SPACED ON A 5.75 B.C.

NOTES:

- HOUSING FOR KUBOTA ENGINES  
D-905, D1005-B, D1105-B, V1205-B,  
V1305-P, AND V1505-B.

**IMPORTANT INSTALLATION NOTE!!!!!!**  
IMPROPER INSTALLATION OF HUB COULD CAUSE  
PREMATURE WEAR AND OR FAILURE. IF YOU  
HAVE A SHAFT LENGTH OTHER THAN THOSE  
SHOWN HERE PLEASE CONTACT DISTRIBUTOR OR  
FACTORY FOR FURTHER INFORMATION. HUB SET  
SCREWS MUST BE PROPERLY TORQUED TO 20  
FT.LBS. EACH. PLEASE CONTACT DISTRIBUTOR  
OR FACTORY FOR ANY FURTHER QUESTIONS.

HEX~FLX COUPLING ASS'Y  
B-S05-HB2-89

10	952182	BOLT KIT	1
9	PURCHASE	5/16 DIA x 1/2 DOWEL PIN	2
8	952088-02	HOUSING	1
2	HB2-89	HEX~FLX HUB	1
1	B-S05	HEX~FLX DRIVE PLATE	1

SYMBOLS	DET.	PART NUMBER	DESCRIPTION	QTY.
FLATNESS SQUARENESS ANGULARITY PARALLELISM PERPENDICULARITY CONCENTRICITY TOTAL RUN OUT CIRCULAR RUN OUT TOTAL RUN OUT FINISH UNLESS OTHERWISE SPECIFIED - REMOVE TAPPED HOLES BREAK ALL SHARP CORNERS .010 TO .020 STAMP OR MARK DRAWING NO.	DO NOT SCALE DRAWING TOLERANCES UNLESS OTHERWISE SPECIFIED MAXIMUM ANGLE ±1/2° FINISH PRACTICAL DEQUAL CIRCULARITY FINISH UNLESS OTHERWISE SPECIFIED - REMOVE TAPPED HOLES BREAK ALL SHARP CORNERS .010 TO .020 STAMP OR MARK DRAWING NO.	1 2 1	HEX~FLX DRIVE PLATE	1



TITLE  
KUBOTA -05 HEX~FLX ASS'Y

DRAWN BY	DATE	DRAWING NO.
CHECKED BY	SCALE	SHEET
REV.	REV.	REV.

THIS DRAWING IS THE PROPERTY OF HAYES MFG. INC. AND IS LOANED  
SUBJECT TO THE CONDITION THAT IT SHALL NOT BE REPRODUCED,  
COPIED, OR IN ANY MANNER DISPOSED OF WITHOUT THE WRITTEN  
CONSENT OF HAYES MFG. INC. IT SHALL BE USED AS A MEANS OF REFERENCE TO WORK FURNISHED BY  
THIS COMPANY ONLY, AND IS NOT TO BE SUBMITTED TO WORK PARTIES  
FOR EXAMINATION WITHOUT OUR CONSENT.