

REV	DATE	CHANGE DESCRIPTION	MOD BY	CK1	CK2
A2	10/31/2006	REMOVED CUMMINS "A" ENGINE.	ZS		

P/N 942000-06
S.A.E. "B" PUMP MOUNT
4" PILOT, (4) HOLES
EQ. SPACED ON A 5.00 B.C.

123243-06
9.499 O.D.
(8) .343 HOLES
ON 8.750 B.C.

124106-12
SPLINE DATA
13 TEETH
16/32 D.P.
30° P.A.
.885 MAJOR
SAE "B"

PUMP
OR
MOTOR

1.65 PUMP SHAFT

SAE #7-1/2

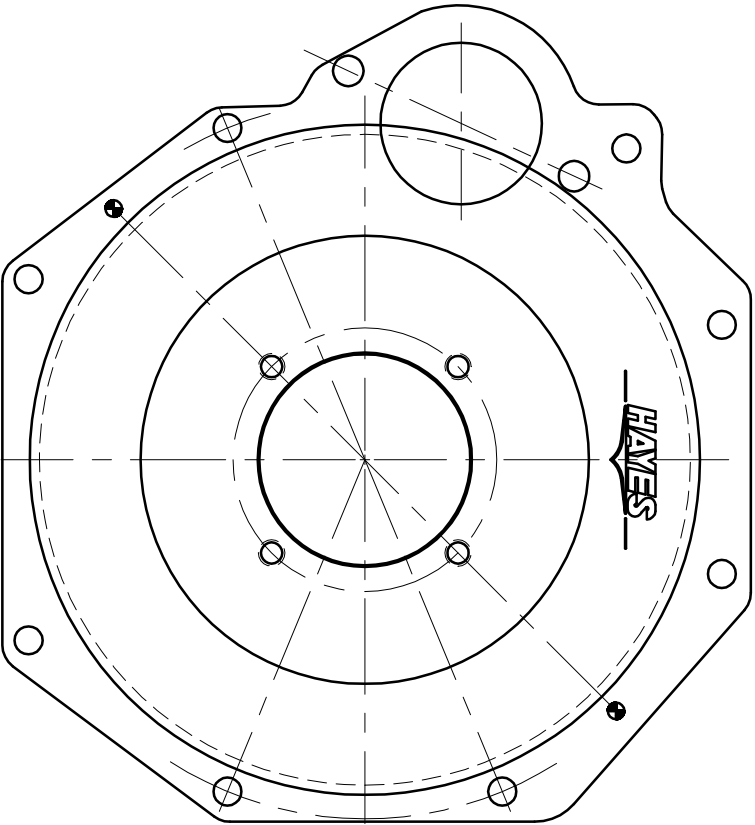
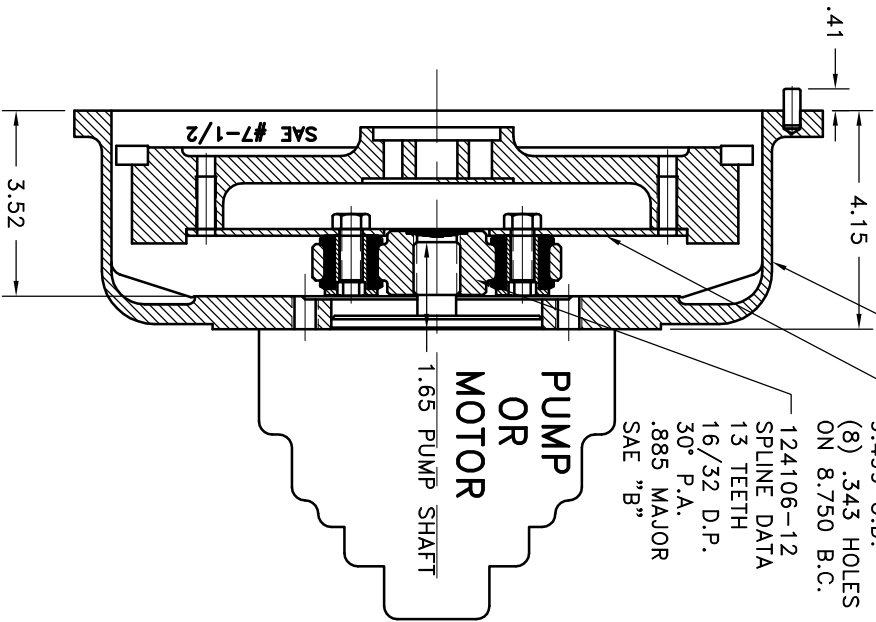

COUPLING ASSY #127470-

UP TO 65 HP

10	PURCHASE	5/16" x 3/4" DOWEL PINS	2
9	942005	BOLT KIT	1
8	942000-06	HOUSING	1
7	801912	GREASE	1
6	HP-1125-S-32	HUBBARD PLUG	1
5	HX200	7/16-20 x 1" HHB	6
4	123727	THREADED BUSHING	6
3	H62500	NEOPRENE INSERT	6
2	124106-12	COUP HUB [13 16/32\3.250]	1
1	123243-06	FLYWHEEL PLATE [7.5\3.250]	1

SYMBOLS		DET.	PART NUMBER	DESCRIPTION	QTY.
	FLATNESS	DO NOT SCALE			
	STRAIGHTNESS	DRAWING			
	ANGULARITY				
	SQUARENESS				
	PARALLELISM	TOLERANCES UNLESS OTHERWISE SPECIFIED			
	PERPENDICULARITY				
	CIRCULARITY	ANGLE 1/16"			
	ROUNDNESS	FRONT ±1/32			
	TOTAL RUN OUT	REAR ±.005			
	CYLINDRICITY	.000 ±.005			
	FINISH	UNLESS OTHERWISE SPECIFIED -			
	BREAK	REMOVE TAPPED HOLE			
	SHARP CORNERS	010 TO 020			
	MARK	DRAWN BY	DATE	DRAWING NO.	
	SCALE	CHECKED BY	SCALE	942013	
	SHEET			OF	REV.



HOUSING AND FLYWHEEL COUPLING ASSY

FITS YANMAR ENGINES: 3TNE-78A, 82A, 84, 88, 3CD1
FITS ISUZU ENGINES: 84(T), 88

THIS DRAWING IS THE PROPERTY OF HAYES MFG. INC. AND IS LOANED TO YOU FOR THE CONDITION OF THE WORK. IT IS NOT TO BE REPRODUCED, COPIED, OR IN ANY MANNER DISPOSED OF WITHOUT THE WRITTEN CONSENT OF HAYES MFG. INC. IT SHALL BE USED AS A MEANS OF REFERENCE TO WORK FURNISHED BY THIS COMPANY ONLY, AND IS NOT TO BE SUBMITTED TO OUTSIDE PARTIES FOR EXAMINATION WITHOUT OUR CONSENT.