

REV	DATE	CHANGE DESCRIPTION	MOD.BY	CK1	CK2
A	05/25/2005	CHANGED HOUSING	ZS	ML	RJH

905000-04
FORD 2.3L HOUSING
S.A.E. "B" PUMP MOUNT (VERT./HORZ.)
4" PILOT DIA.
(4) 1/2-13 TAPPED HOLES
ON A 5.750 B.C.

124203
11" O.D.
(6) 11/32 HOLES EQ.
SPACED ON A 10.25 B.C.
(3) 1/4" DOWEL HOLES EQ.
SPACED ON A 10.25 B.C.

124106-02
SPLINE DATA
15 TEETH
16/32 D.P.
30° P.A.
1.016 MAJOR
SAE "B-B"

1.81 SHAFT LENGTH

PUMP
OR
MOTOR

"H" ON PLATE
IS ON HUB SIDE.

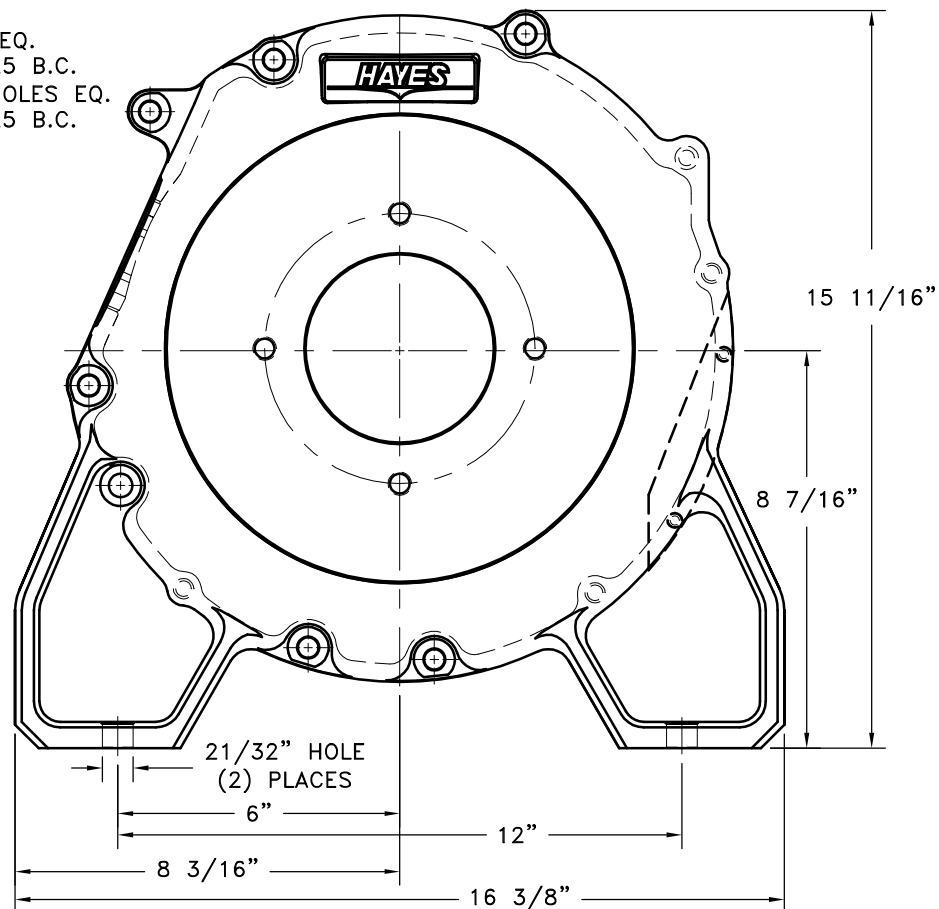

COUPLING ASS'Y #124210

9	905002	BOLT KIT	1
8	905000-04	HOUSING	1
7	801912	GREASE	1
6	HP-1125-S-32	HUBBARD PLUG	1
5	123727	THREADED BUSHING	6
4	HX200	7/16-20 x 1" HHB	6
3	H62500	NEOPRENE INSERT	6
2	124106-02	COUPLING HUB	1
1	124203	FLYWHEEL PLATE	1

SYMBOLS	DET.	PART NUMBER	DESCRIPTION	QTY.
FLATNESS STRAIGHTNESS ANGULARITY SQUARENESS PARALLELISM CONCENTRICITY TRUE POSITION ROUNDNESS CIRCULAR RUN OUT TOTAL RUN OUT CYLINDRICITY FINISH	DO NOT SCALE DRAWING TOLERANCES UNLESS OTHERWISE SPECIFIED 12/31 MAXIMUM ANGLE ±1/2° FRACTION ±1/32 DECIMAL .00 ±.01 .000 ±.005 .0000 ±.0005	HAYES MANUFACTURING INC. ® TITLE FORD 2.3L COUPLING & HOUSING ASSY		
- UNLESS OTHERWISE SPECIFIED - REMOVE FIRST THREAD ON ALL TAPPED HOLES BREAK ALL SHARP CORNERS .010 TO .020 STAMP OR MARK DRAWING NO.		DRAWN BY SIETING CHECKED BY RJH	DATE 03-17-05 SCALE	DRAWING NO. 905004 SHEET OF REV.

THIS DRAWING IS THE PROPERTY OF HAYES MFG. INC. AND IS LOANED
SUBJECT TO THE CONDITION THAT IT SHALL NOT BE REPRODUCED,
COPIED, LOANED OR OTHERWISE DISPOSED OF, DIRECTLY OR INDIRECTLY,
IT SHALL BE USED AS A MEANS OF REFERENCE TO WORK FURNISHED BY
THIS COMPANY ONLY AND IS NOT TO BE SUBMITTED TO OUTSIDE PARTIES
FOR EXAMINATION WITHOUT OUR CONSENT.