

REV	DATE	CHANGE DESCRIPTION	MOD.BY	CK1	CK2
A1	07/16/2003	FIXED # OF GREASE ZERTS.	ZS	HM	RJH

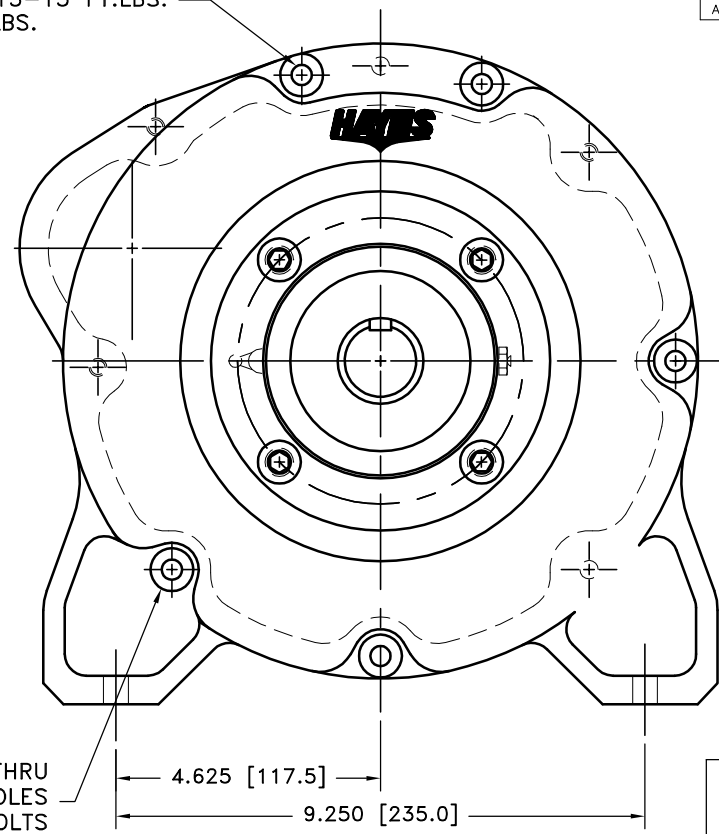
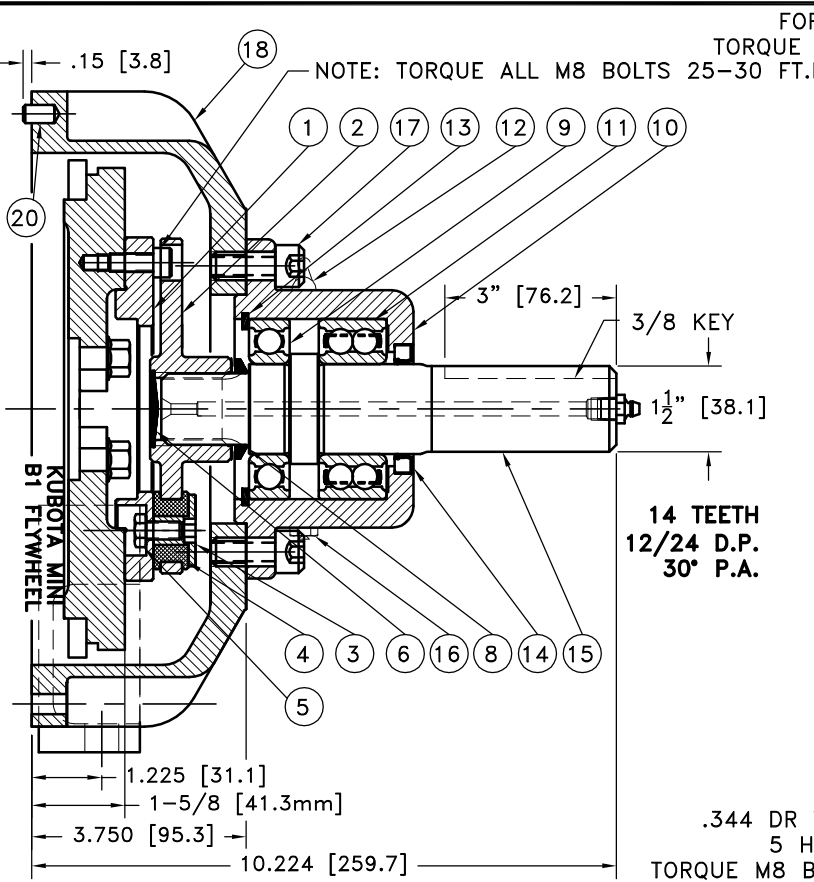

QTY.	DESCRIPTION	PART NUMBER	DET.
1	FLYWHEEL PLATE	124280	1
1	COUPLING HUB	125745	2
5	THREADED BUSHING	123729-01	3
5	NEOPRENE INSERT	H52500	4
5	5/16-24x5/8 HUBBARD PLUG	R-0017-01	6
1	V-RING	VS-032	8
1	BEARING	208P	9
1	BEARING HOUSING	125007	10
1	DOUBLE BEARING	5208WD	11
2	GREASE ZERT	600000	12
1	SPIROLOX SNAP RING	RR-314	13
1	SEAL	CRW1-R-15830	14
1	SPLINED SHAFT	126412	15
1	RELIEF VALVE	1093K11	16
4	1/2-13-1-1/8 SHCS	740000	17
1	HOUSING	930114-08	18
1	BOLT KIT	930112	19
2	5/16 DIA x 1/2 DOWEL	PURCHASE	20
1	C-32-U-200 OR C36-2-U-2000 BLACK PLUG	21	

- NOTES:
- LIGHTLY GREASE INTERNAL AND EXTERNAL AREA OF SPLINE AT ASSEMBLY USING 1912 COUPLING GREASE (OVER GREASING COULD CAUSE A HYDRAULIC TYPE LIFT ON SEALS).
 - GREASE BEARING HOUSING UNTIL PIN EXTENDS FROM PRESSURE RELIEF VALVE (LOCATED 180° FROM GREASE ZERT). USE OF AN UNLEADED EXTREME PRESSURE LITHIUM GREASE, WITH NLGI NO.2 GRADE IS RECOMMENDED. RUN TIME BETWEEN GREASINGS NOT TO EXCEED 2,000 HOURS.
 - WARNING!!!** INJURY OR DEATH FROM A ROTATING STUB SHAFT CAN OCCUR IF A CONDITION EXISTS WHICH WOULD CAUSE THE SHAFT TO BREAK OR COME APART FROM ANY PART OF THE ASSEMBLY. DEPENDING UPON THE APPLICATION (FOR EXAMPLE, FAN, PULLEY, SHEAVE, ETC.), THE AREA AROUND THE STUB SHAFT MUST BE SUFFICIENTLY GUARDED SO THAT IN THE EVENT OF FAILURE, THE GUARD WILL CONTAIN ANY AIRBORNE PARTS.

NOTE:
ASSEMBLY WORKS WITH FLYWHEELS
C-1(16851-25118) AND C-2(16861-25112)
AND WITH STARTER PLATE
E-2(19666-04621)

BEARING SUPPORTED
STUB SHAFT SUB-ASS'Y
#126413

COUPLING ASS'Y
#125742

ASSEMBLY NOTE:

ENSURE THAT THE GREASE ZERT AND RELIEF VALVE ARE LOCATED HORIZONTAL WHEN MOUNTING ON TO PUMP MOUNT PLATE.

4. HOUSING FOR KUBOTA ENGINES Z442-B, Z482-B, D662-B, D722-B, WG600-B, WG750-B

THIS DRAWING IS THE PROPERTY OF HAYES MFG. INC. AND IS LOANED SUBJECT TO THE CONDITION THAT IT SHALL NOT BE REPRODUCED, COPIED, LOANED OR OTHERWISE DISPOSED OF, DIRECTLY OR INDIRECTLY. IT SHALL BE USED AS A MEANS OF REFERENCE TO WORK FURNISHED BY THIS COMPANY ONLY AND IS NOT TO BE SUBMITTED TO OUTSIDE PARTIES FOR EXAMINATION WITHOUT OUR CONSENT.

REF. 930168 FOR NO FEET

SYMBOLS	DET.	PART NUMBER	DESCRIPTION	QTY.
▱ FLATNESS ≡ STRAIGHTNESS ∠ ANGULARITY ⊥ PERPENDICULARITY ∥ PARALLELISM ⊙ CONCENTRICITY ⊕ TRUE POSITION ○ ROUNDNESS ⊖ CIRCULAR RUN OUT ⊖ TOTAL RUN OUT ⊖ CYLINDRICITY √ FINISH	DO NOT SCALE DRAWING TOLERANCES UNLESS OTHERWISE SPECIFIED 125 MAXIMUM ANGLE ±1/2° FRACTION ±1/32 DECIMAL .00 ±.01 .000 ±.005 .0000 ±.0005		 HAYES MANUFACTURING INC. ® TITLE KUBOTA MINI BEARING STUB SHAFT ASS'Y MATERIAL	
CLASS	MAKE: <input type="checkbox"/> BUY: <input type="checkbox"/>	DRAWN BY SIETING	DATE 04-21-03	DRAWING NO. 930178
DESCRIPTION	CHECKED BY RJH	SCALE	SHEET OF	REV.