

REV	DATE	CHANGE DESCRIPTION	MOD.BY	CK1	CK2
A2	10/31/2006	REMOVED CUMMINS "A" ENGINE.	ZS	ML	RJH

P/N 942000-06
S.A.E. "B" PUMP MOUNT
4" PILOT, (4) HOLES
EQ. SPACED ON A 5.00 B.C.

123243-06
9.499 O.D.
(8) .343 HOLES
ON 8.750 B.C.

124106-12
SPLINE DATA
13 TEETH
16/32 D.P.
30° P.A.
.885 MAJOR
SAE "B"

PUMP
OR
MOTOR

1.65 PUMP SHAFT

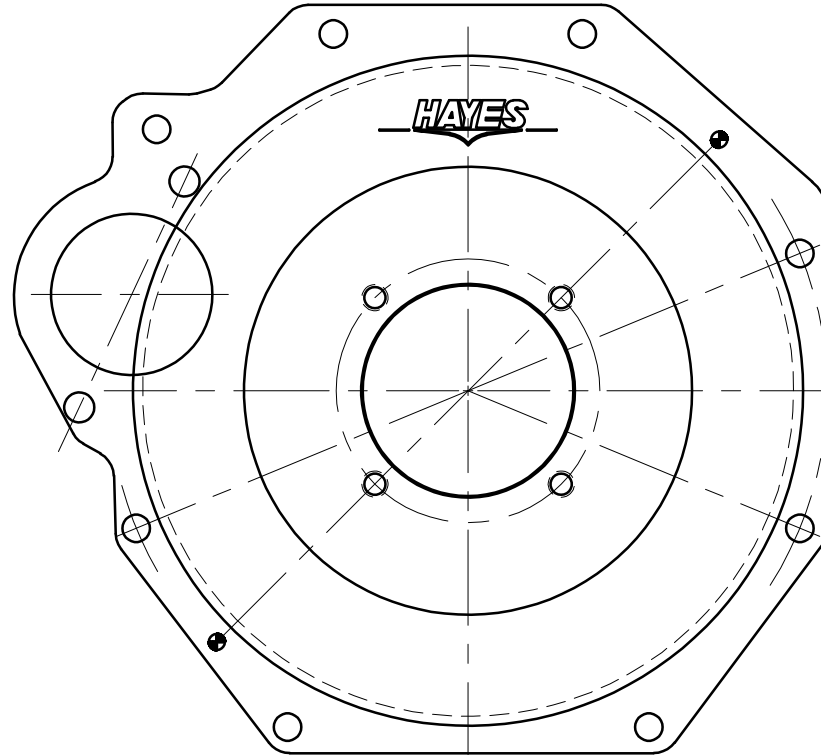
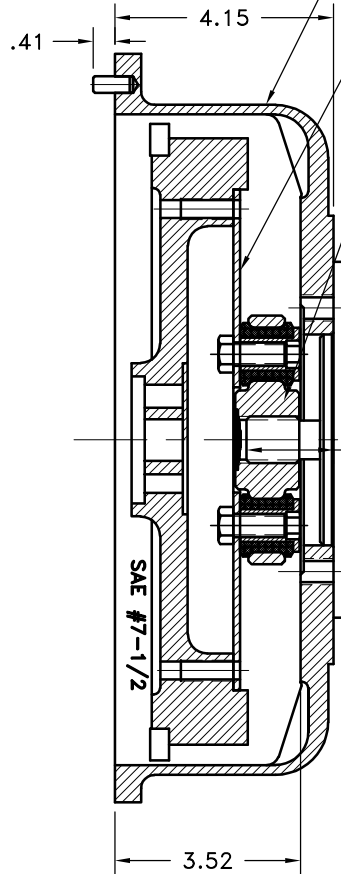

COUPLING ASSY #127470

UP TO 65 HP

10	SD200X5/16X1/2	5/16 X 1/2 SPRING DOWEL	2
9	942005	BOLT KIT	1
8	942000-06	HOUSING	1
7	801912	GREASE	1
6	HP-1125-S-32	HUBBARD PLUG	1
5	BOLT	7/16-20 x 1" HHB	6
4	123727	THREADED BUSHING	6
3	H62500	NEOPRENE INSERT	6
2	124106-12	COUP HUB [13 16/32\3.250]	1
1	123243-06	FLYWHEEL PLATE [7.5\3.250]	1

FITS YANMAR ENGINES: 3TNE-78A, 82A, 84, 88, 3CD1
FITS ISUZU ENGINES: 84(T), 88

THIS DRAWING IS THE PROPERTY OF HAYES MFG. INC. AND IS LOANED
SUBJECT TO THE CONDITION THAT IT SHALL NOT BE REPRODUCED,
COPIED, LOANED OR OTHERWISE DISPOSED OF, DIRECTLY OR INDIRECTLY.
IT SHALL BE USED AS A MEANS OF REFERENCE TO WORK FURNISHED BY
THIS COMPANY ONLY AND IS NOT TO BE SUBMITTED TO OUTSIDE PARTIES
FOR EXAMINATION WITHOUT OUR CONSENT.

SYMBOLS FLATNESS STRAIGHTNESS ANGULARITY PERPENDICULARITY PARALLELISM CONCENTRICITY TRUE POSITION ROUNDNESS CIRCULAR RUN OUT TOTAL RUN OUT CYLINDRICITY FINISH		DET. PART NUMBER DESCRIPTION QTY. DO NOT SCALE DRAWING TOLERANCES UNLESS OTHERWISE SPECIFIED .125" MAXIMUM ANGLE ±1/2° FRACTION ±1/32 DECIMAL .00 ±.01 .000 ±.005 .0000 ±.0005	HAYES MANUFACTURING INC. ® TITLE HOUSING AND FLYWHEEL COUPLING ASSY MATERIAL
CLASS YANMAR DESCRIPTION YNM3TN,13T16/32,B4,65	MAKE: <input checked="" type="checkbox"/> BUY: <input type="checkbox"/> DRAWN BY SIETING CHECKED BY RJH	DATE 02-26-04 SCALE	DRAWING NO. 942013 SHEET OF REV.