

REV	DATE	CHANGE DESCRIPTION	MOD.BY	CK1	CK2
C	06/09/2016	CHANGED SEAL	BSL	HM	JM

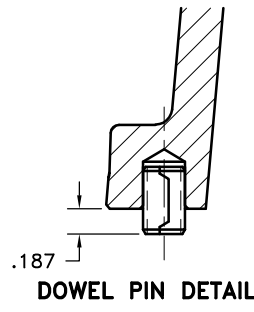
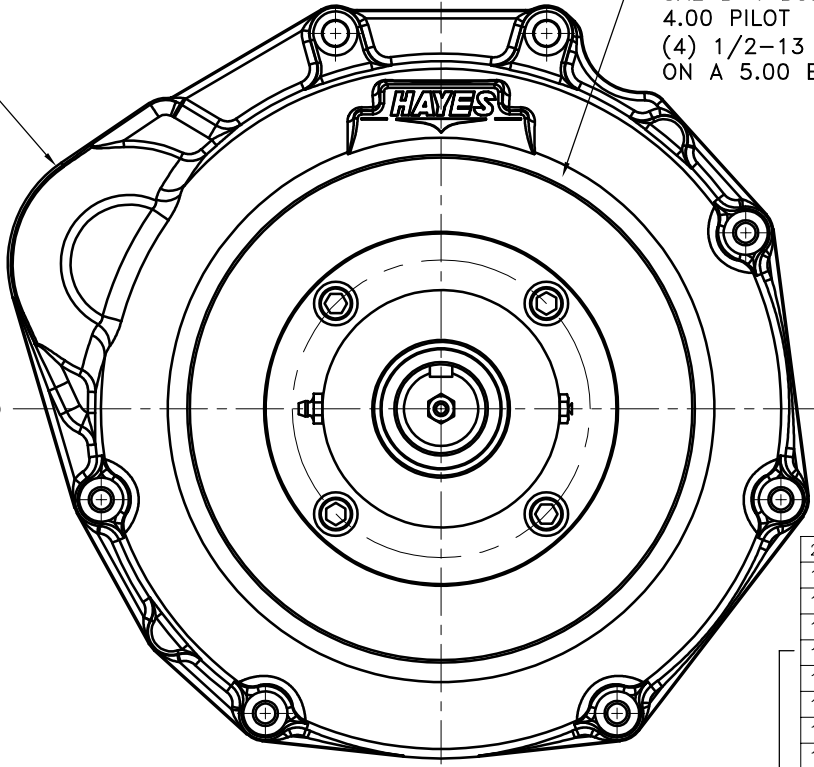
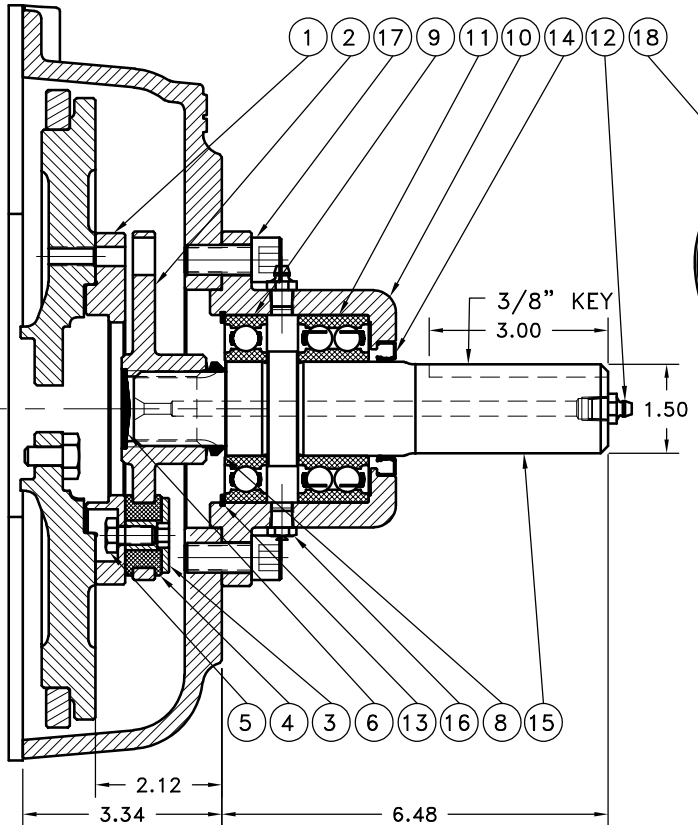

946000-04  
SAE B 4 BOLT PUMP MOUNT  
4.00 PILOT  
(4) 1/2-13 TAPPED HOLES  
ON A 5.00 B.C.

UP TO 50 HP

QTY.	DESCRIPTION	PART NUMBER	DET.
1	BOLT KIT (PRE-ASSEMBLED)	946002	20
2	SD200x5/16x1/2 SPRING DOWEL	19	19
1	HOUSING [YNM3TNM]	946000-04	18
4	1/2-13x1-1/8 SHCS D	17	17
1	RELIEF VALVE	1093K11	16
1	SPLINED SHAFT [1-1/2,3/8,3]	126412	15
1	SEAL	132015	14
1	SPIROLOX SNAP RING	RR-314	13
1	GREASE ZERK	600000	12
1	DOUBLE BEARING	5208WD	11
1	BEARING HOUSING	125007	10
1	BEARING	208KD	9
1	V-RING	VS-032	8
1	GREASE	801912	7
1	HUBBARD PLUG	R-0017-01	6
5	5/16-24x5/8 HHB Y D	BOLT	5
5	NEOPRENE INSERT	H52500	4
5	THREADED BUSHING	123729-01	3
1	COUPLING HUB	125745	2
1	FLYWHEEL PLATE	124280	1

BEARING SUPPORTED  
STUB SHAFT SUB-ASS'Y  
#126413

COUPLING ASS'Y  
#125742

- NOTES:**
- LIGHTLY GREASE INTERNAL AND EXTERNAL AREA OF SPLINE AT ASSEMBLY USING SUPPLIED COUPLING GREASE (OVER GREASING COULD CAUSE A HYDRAULIC TYPE LIFT ON SEALS).
  - AT ASSEMBLY GREASE BEARING HOUSING UNTIL PIN EXTENDS FROM PRESSURE RELIEF VALVE (LOCATED 180° FROM GREASE ZERK).** USE OF AN UNLEADED EXTREME PRESSURE LITHIUM GREASE, WITH NLGI NO.2 GRADE IS RECOMMENDED. RUN TIME BETWEEN GREASINGS NOT TO EXCEED 2,000 HOURS.
  - WARNING!!!** INJURY OR DEATH FROM A ROTATING STUB SHAFT CAN OCCUR IF A CONDITION EXISTS WHICH WOULD CAUSE THE SHAFT TO BREAK OR COME APART FROM ANY PART OF THE ASSEMBLY. DEPENDING UPON THE APPLICATION (FOR EXAMPLE, FAN, PULLEY, SHEAVE, ETC.), THE AREA AROUND THE STUB SHAFT MUST BE SUFFICIENTLY GUARDED SO THAT IN THE EVENT OF FAILURE, THE GUARD WILL CONTAIN ANY AIRBORNE PARTS.

**NOTES:**  
FITS ALL YANMAR 3TNM (MINIMAX) ENGINES WITH STARTER PLATE BACK END.

USE SUPPLIED COUPLING GREASE ON BOTH INTERNAL AND EXTERNAL SPLINE.

**ASSEMBLY NOTE:**

ENSURE THAT THE GREASE ZERK AND RELIEF VALVE ARE LOCATED HORIZONTAL WHEN MOUNTING ON TO PUMP MOUNT PLATE OR HOUSING.

THIS DRAWING IS THE PROPERTY OF HAYES MFG. INC. AND IS LOANED SUBJECT TO THE CONDITION THAT IT SHALL NOT BE REPRODUCED, COPIED, LOANED OR OTHERWISE DISPOSED OF, DIRECTLY OR INDIRECTLY. IT SHALL BE USED AS A MEANS OF REFERENCE TO WORK FURNISHED BY THIS COMPANY ONLY AND IS NOT TO BE SUBMITTED TO OUTSIDE PARTIES FOR EXAMINATION WITHOUT OUR CONSENT.

SYMBOLS		DET.	PART NUMBER	DESCRIPTION	QTY.
/ FLATNESS - STRAIGHTNESS L ANGULARITY ⊥ PERPENDICULARITY // PARALLELISM ⊙ CONCENTRICITY ⊕ TRUE POSITION ○ ROUNDNESS ⊖ CIRCULAR RUN OUT ⊖ TOTAL RUN OUT ⊖ CYLINDRICITY ✓ FINISH		DO NOT SCALE DRAWING			
TOLERANCES UNLESS OTHERWISE SPECIFIED 125 MAXIMUM ANGLE ±1/2° FRACTION ±1/32 DECIMAL .00 ±.01 .000 ±.005 .0000 ±.0005					
CLASS BS ASSY		MAKE: <input checked="" type="checkbox"/> BUY: <input type="checkbox"/>		DRAWN BY SIETING	
DESCRIPTION YNM3TN,1-1/2,3,50		DATE 09-24-08		DRAWING NO. 946004	
		CHECKED BY R/JH		SCALE SHEET OF REV.	