

REV	DATE	CHANGE DESCRIPTION	MOD.BY	CK1	CK2

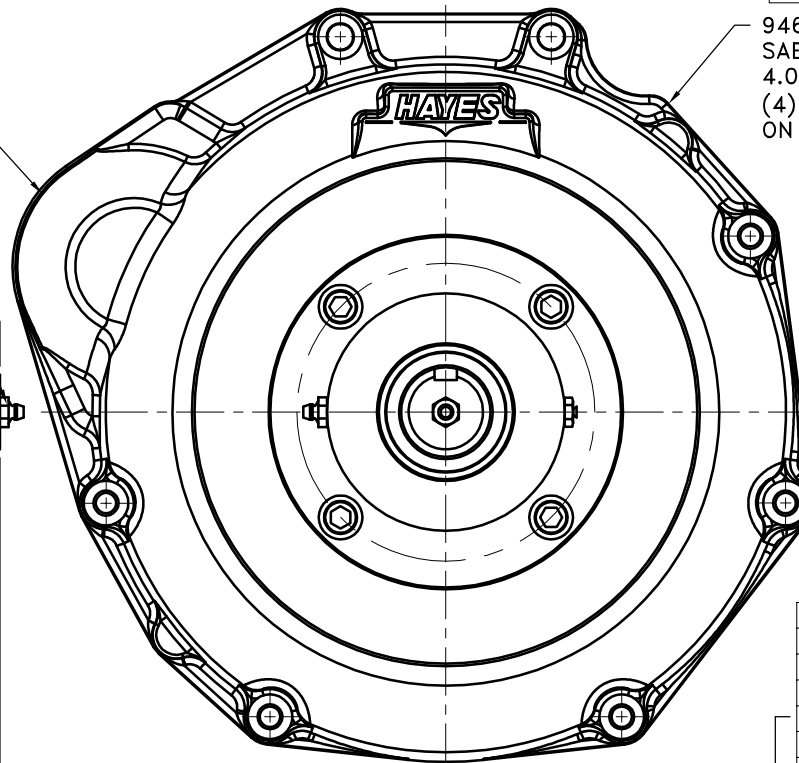

946000-04
SAE B 4 BOLT PUMP MOUNT
4.00 PILOT
(4) 1/2-13 TAPPED HOLES
ON A 5.00 B.C.

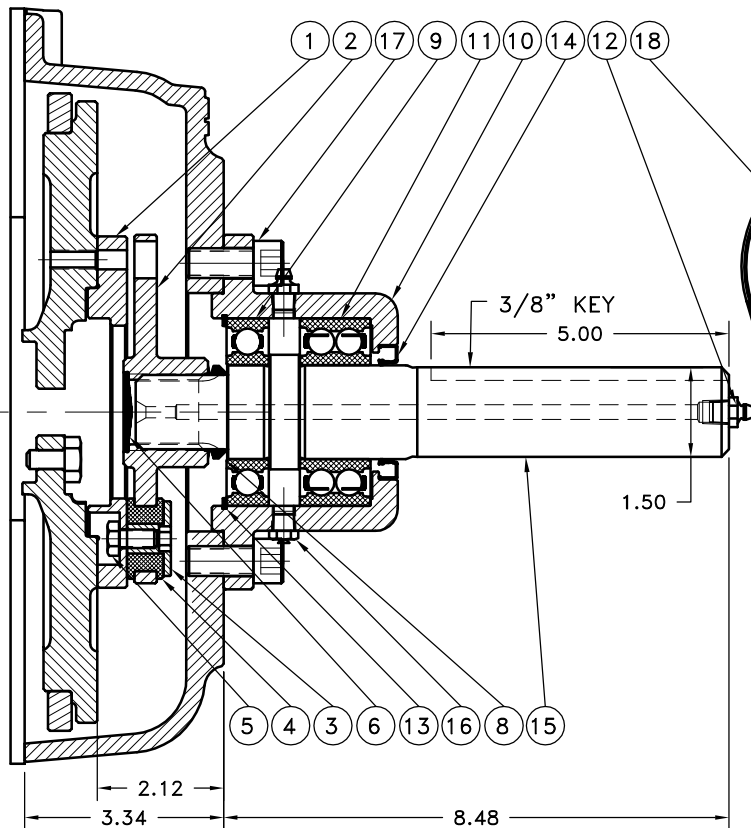
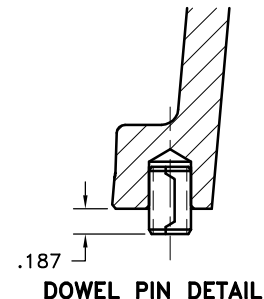

UP TO 50 HP

20	946002	BOLT KIT	1
19	SD200x5/16x1/2	5/16 x 1/2 SPRING DOWEL	2
18	946000-04	HOUSING	1
17	BOLT	1/2-13x1-1/8 SHCS D	4
16	1093K11	RELIEF VALVE	1
15	125743	SPLINED SHAFT	1
14	15830	SEAL	1
13	RR-314	SPIROLOX SNAP RING	1
12	600000	GREASE ZERK	1
11	5208WD	DOUBLE BEARING	1
10	125007	BEARING HOUSING	1
9	208KD	BEARING	1
8	VS-032	V-RING	1
7	801912	GREASE	1
6	R-0017-01	HUBBARD PLUG	1
5	BOLT	5/16-24x5/8 HHB Y D	5
4	H52500	NEOPRENE INSERT	5
3	123729-01	THREADED BUSHING	5
2	125745	COUPLING HUB	1
1	124280	FLYWHEEL PLATE	1

NOTES:

1. LIGHTLY GREASE INTERNAL AND EXTERNAL AREA OF SPLINE AT ASSEMBLY USING SUPPLIED COUPLING GREASE (OVER GREASING COULD CAUSE A HYDRAULIC TYPE LIFT ON SEALS).
2. **AT ASSEMBLY GREASE BEARING HOUSING UNTIL PIN EXTENDS FROM PRESSURE RELIEF VALVE (LOCATED 180° FROM GREASE ZERK).** USE OF AN UNLEADED EXTREME PRESSURE LITHIUM GREASE, WITH NLGI NO.2 GRADE IS RECOMMENDED. RUN TIME BETWEEN GREASINGS NOT TO EXCEED 2,000 HOURS.
3. **WARNING!!!** INJURY OR DEATH FROM A ROTATING STUB SHAFT CAN OCCUR IF A CONDITION EXISTS WHICH WOULD CAUSE THE SHAFT TO BREAK OR COME APART FROM ANY PART OF THE ASSEMBLY. DEPENDING UPON THE APPLICATION (FOR EXAMPLE, FAN, PULLEY, SHEAVE, ETC.), THE AREA AROUND THE STUB SHAFT MUST BE SUFFICIENTLY GUARDED SO THAT IN THE EVENT OF FAILURE, THE GUARD WILL CONTAIN ANY AIRBORNE PARTS.

THIS DRAWING IS THE PROPERTY OF HAYES MFG. INC. AND IS LOANED SUBJECT TO THE CONDITION THAT IT SHALL NOT BE REPRODUCED, COPIED, LOANED OR OTHERWISE DISPOSED OF, DIRECTLY OR INDIRECTLY. IT SHALL BE USED AS A MEANS OF REFERENCE TO WORK FURNISHED BY THIS COMPANY ONLY AND IS NOT TO BE SUBMITTED TO OUTSIDE PARTIES FOR EXAMINATION WITHOUT OUR CONSENT.

ASSEMBLY NOTE:

ENSURE THAT THE GREASE ZERK AND RELIEF VALVE ARE LOCATED HORIZONTAL WHEN MOUNTING ON TO PUMP MOUNT PLATE OR HOUSING.

NOTES:

FITS ALL YANMAR 3TNM (MINIMAX) ENGINES WITH STARTER PLATE BACK END.

USE SUPPLIED COUPLING GREASE ON BOTH INTERNAL AND EXTERNAL SPLINE.

BEARING SUPPORTED
STUB SHAFT SUB-ASS'Y
#125744

COUPLING ASS'Y
#125742

SYMBOLS	DET.	PART NUMBER	DESCRIPTION	QTY.
— FLATNESS — STRAIGHTNESS — ANGULARITY — PERPENDICULARITY — PARALLELISM — CONCENTRICITY — TRUE POSITION — ROUNDNESS — CIRCULAR RUN OUT — TOTAL RUN OUT — CYLINDRICITY — FINISH	DO NOT SCALE DRAWING TOLERANCES UNLESS OTHERWISE SPECIFIED .125" MAXIMUM ANGLE ±1/2° FRACTION ±1/32 DECIMAL .00 ±.01 .000 ±.005 .0000 ±.0005	MAKE: <input type="checkbox"/> BUY: <input type="checkbox"/>	HAYES MANUFACTURING INC. ® TITLE YANMAR 3TNM (MINIMAX) STUB SHAFT ASS'Y MATERIAL	DRAWN BY SIETING DATE 09-19-2011 CHECKED BY R/JH SCALE DRAWING NO. 946011 SHEET OF REV.