

REV	DATE	CHANGE DESCRIPTION	MOD.BY	CK1	CK2

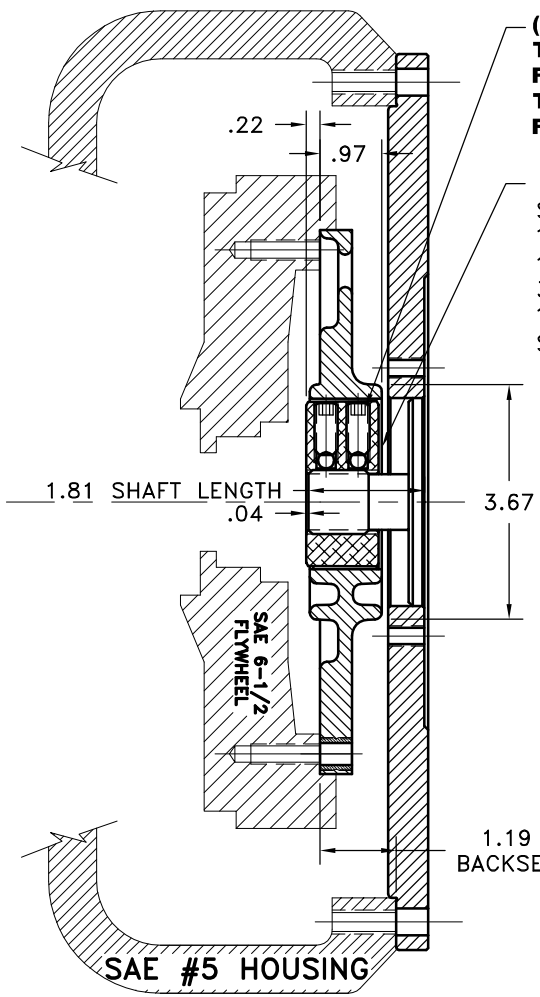

**(2) 3/8" SET SCREWS
TORQUE BOTH TO 25
FT. LBS USING
TORQUE WRENCH AT
FINAL INSTALLATION**

HB1-89
SPLINE DATA
15 TEETH
16/32 D.P.
30° P.A.
1.000 MAJOR
SAE "B-B"

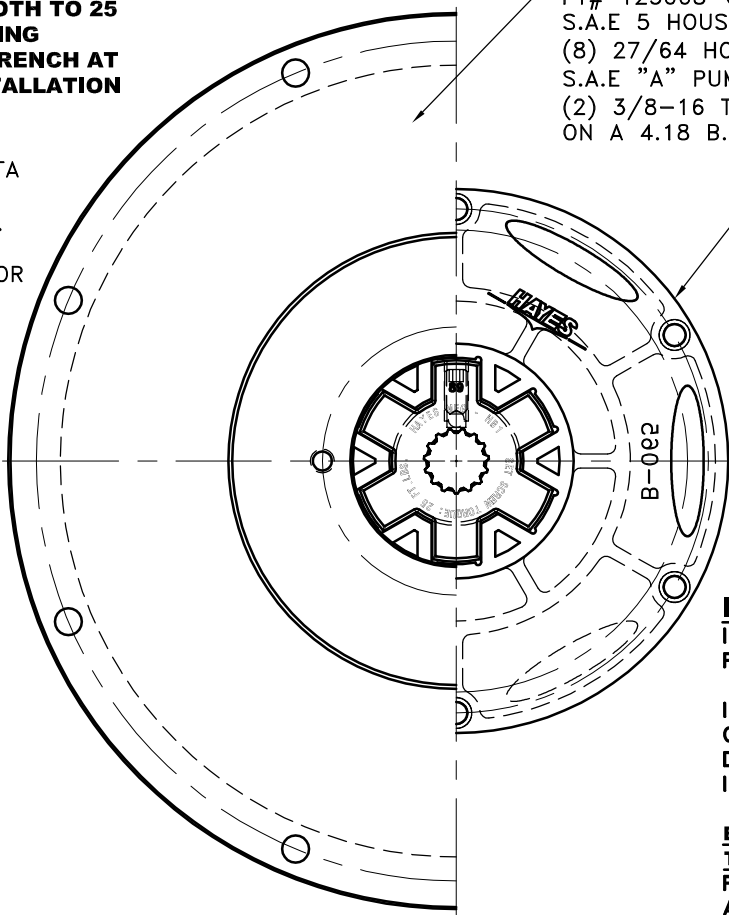

PT# 123008-GN2
S.A.E 5 HOUSING MOUNT, 12.38 PILOT
(8) 27/64 HOLES ON A 13.13 B.C.
S.A.E "A" PUMP MOUNT, 3.25 PILOT
(2) 3/8-16 TAPPED HOLES
ON A 4.18 B.C.

B-065
S.A.E. 6 1/2 FIBERGLASS REINFORCED
NYLON DRIVE PLATE
(6) 11/32 HOLES EQ.
SPACED ON A 7 7/8 B.C.
"B" SERIES DRIVE

IMPORTANT INSTALLATION NOTE!!!!
IMPROPER INSTALLATION OF HUB COULD CAUSE
PREMATURE WEAR AND OR FAILURE.

IF YOU HAVE QUESTIONS CONCERNING LOCATION
OF METAL HUB ON PUMP SHAFT PLEASE CONTACT
DISTRIBUTOR OR FACTORY FOR FURTHER
INFORMATION

**BOTH HUB SET SCREWS MUST BE PROPERLY
TORQUED TO 25 FT.LBS. USING TORQUE WRENCH.**
PLEASE CONTACT DISTRIBUTOR OR FACTORY FOR
ANY FURTHER QUESTIONS.

**"B" SERIES TORQUE RANGE
30-75 HP**

**NOTE: THIS STEP IS IMPORTANT TO
ENSURE FULL SPLINE ENGAGEMENT.**

- 1) PRESET HUB ON SHAFT AS SHOWN.
- 2) IF YOUR PUMP SHAFT VARIES FROM THE DRAWN
SHAFT LENGTH, CONTACT FACTORY FOR
RECOMMENDATIONS.
- 3) **TORQUE BOTH SET SCREWS TO 25 FT.LBS. USING
TORQUE WRENCH.**
- 4) SHAFT SHOULD HAVE FULL SPLINE ENGAGEMENT INTO
HUB, IF NOT CONTACT FACTORY FOR
RECOMMENDATIONS (231) 879-3372.

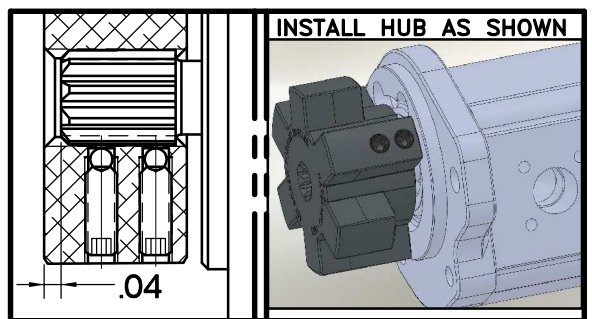

SET HUB AS SHOWN

THIS DRAWING IS THE PROPERTY OF HAYES MFG. INC. AND IS LOANED
SUBJECT TO THE CONDITION THAT IT SHALL NOT BE REPRODUCED,
COPIED, LOANED OR OTHERWISE DISPOSED OF, DIRECTLY OR INDIRECTLY.
IT SHALL BE USED AS A MEANS OF REFERENCE TO WORK FURNISHED BY
THIS COMPANY ONLY AND IS NOT TO BE SUBMITTED TO OUTSIDE PARTIES
FOR EXAMINATION WITHOUT OUR CONSENT.

DET.	PART NUMBER	DESCRIPTION	QTY.
3	123008-GN2	PUMP MOUNT PLATE	1
2	HB1-89	B SERIES HEX~FLX HUB	1
1	B-065	SAE 6 1/2 HEX~FLX DRIVE PLATE	1

SYMBOLS		DET.		PART NUMBER		DESCRIPTION		QTY.	
—	FLATNESS	DO NOT SCALE							
—	STRAIGHTNESS	DRAWING							
∠	ANGULARITY	TOLERANCES UNLESS							
⊥	PERPENDICULARITY	OTHERWISE SPECIFIED							
∥	PARALLELISM	125° MAXIMUM							
⊙	CONCENTRICITY	ANGLE ±1/2°							
⊕	TRUE POSITION	FRACTION ±1/32							
⊖	ROUNDNESS	DECIMAL							
⊘	CIRCULAR RUN OUT	.00 ±.01							
⊙	TOTAL RUN OUT	.000 ±.005							
⊘	CYLINDRICITY	.0000 ±.0005							
∇	FINISH								

CLASS	MAKE: <input type="checkbox"/> BUY: <input type="checkbox"/>	DRAWN BY	DATE	DRAWING NO.
DESCRIPTION		SIETING	07-03-2013	B-065-HB1-89-GN2
		CHECKED BY	SCALE	SHEET OF REV.
		RJH		