

CUSTOMER

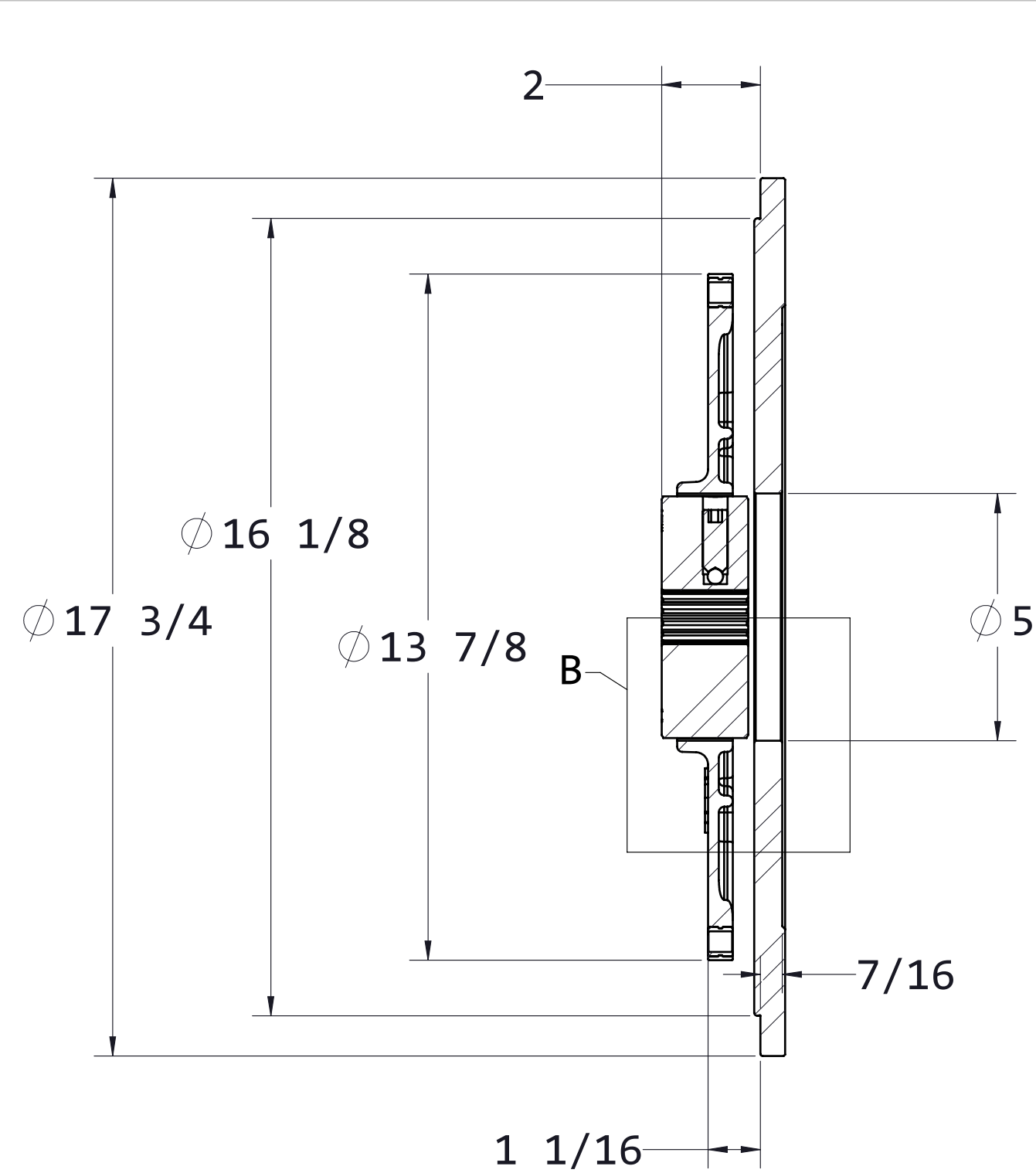

SECTION A-A
SCALE 1 : 3

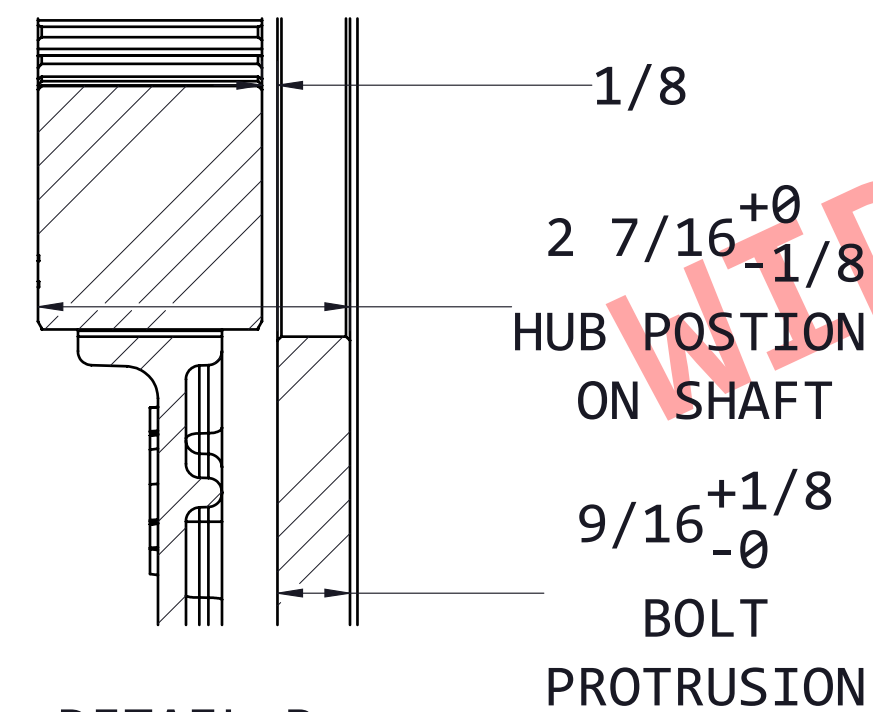

DETAIL B
SCALE 2 : 3

PUMP DRIVE SPECS	
FLYWHEEL	SAE 11.5
HOUSING	SAE 3
PUMP FLANGE	SAE C 2&4 BOLT
PUMP SHAFT	14T 12/24

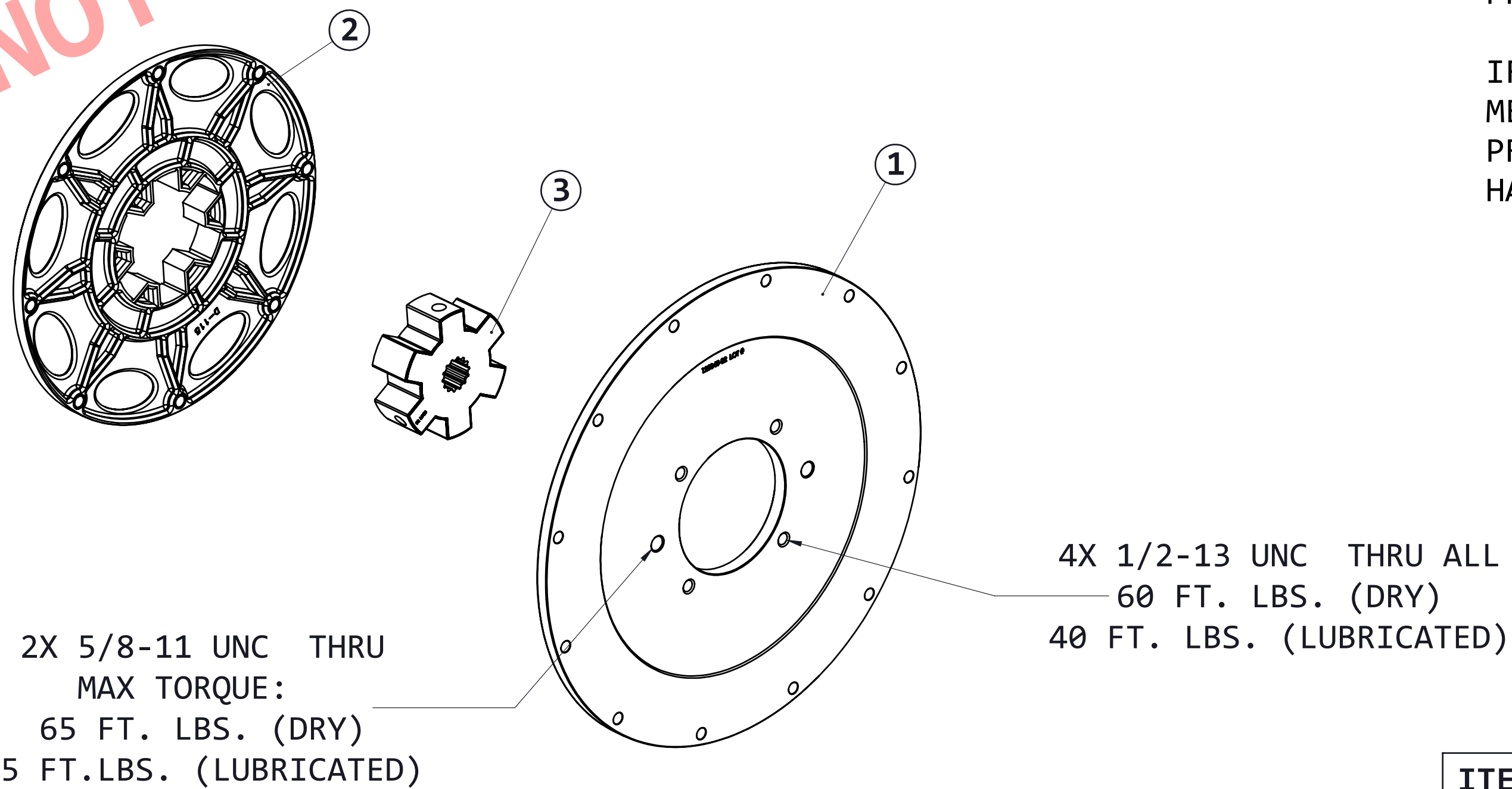
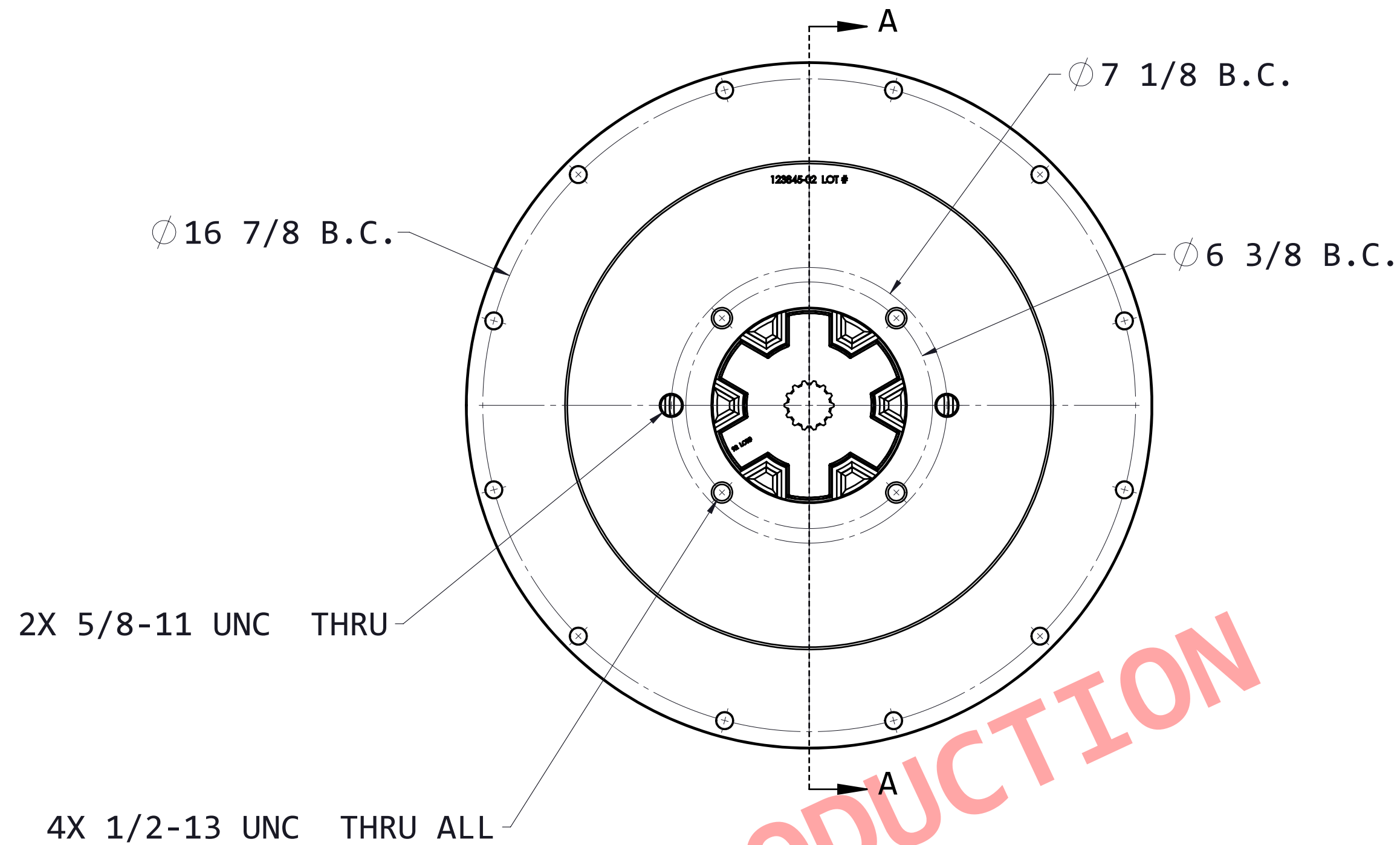

INSTALLATION INSTRUCTIONS

FLYWHEEL MOUNT

- BE SURE FLYWHEEL IS CLEAN AND FREE OF RUST AND DEBRIS.
- INSTALL HEX-FLX DRIVE PLATE TO FLYWHEEL USING PROPER INSTALLATION ORIENTATION.
(SEE DIAGRAMS)
- HAYES MANUFACTURING RECOMMENDS THE USE OF GRADE 8/CLASS 10.9 FASTENERS, NO LOCK WASHERS, AND CHOICE OF RED OR BLUE THREAD LOCKER. TORQUE BOLTS TO ENGINE MFG. SPECS OR STANDARD TORQUE FOR GRADE/CLASS AND SIZE OF THREAD.

DRIVE HUB MOUNTING

- BE SURE PUMP SHAFT IS CLEAN AND FREE OF GREASE OR OIL
- INSTALL HUB ONTO PUMP SHAFT USING PROPER ORIENTATION. (SEE DIAGRAMS)
- HUB LOCATION IS IMPORTANT TO ENSURE PROPER ASSEMBLY. WHILE MAINTAINING HUB LOCATION, TORQUE SET SCREWS TO 25 FT.LBS.

WARNING!!! BE SURE THAT BOTH SET SCREWS ARE OVER THE PUMP SHAFT OR DAMAGE WILL OCCUR TO THE HUB.

WARNINGS!!!

IMPROPER INSTALLATION OF HUB COULD CAUSE
PREMATURE WEAR AND/OR FAILURE.

IF YOU HAVE QUESTIONS CONCERNING LOCATION OF METAL HUB ON PUMP SHAFT OR ANY INSTALLATION PROCEDURES, PLEASE CONTACT DISTRIBUTOR OR HAYES MANUFACTURING FOR FURTHER INFORMATION.

ITEM NO.	PART NUMBER	DESCRIPTION	QTY
1	123845-02	PUMP MOUNT PLATE	1
2	D-115	SAE 11.5 HEX-FLX DRIVE PLATE	1
3	HD3-92	HEX-FLX HUB	1



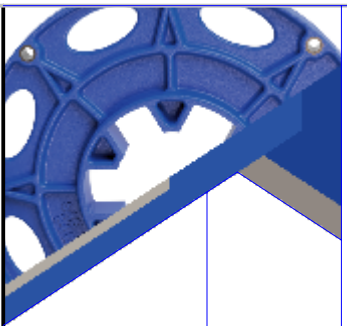











NOT FOR MANUFACTURING PURPOSES



NAME	DATE
VHA	07-17-25
DRAWN	
ENG APR	
QA APR	
PCM APR	

PROPRIETARY AND CONFIDENTIAL
 THE INFORMATION CONTAINED IN THIS DRAWING IS THE SOLE PROPERTY OF HAYES. IT IS TO BE USED ONLY IN PART OR AS A GUIDE WITHOUT THE WRITTEN PERMISSION OF HAYES. MANUFACTURING IS PROHIBITED.

<u>CLASS</u>	
SAE 11.5	
<u>DESCRIPTION</u>	
11-1/2, 3, 14T12/24, C24	
<u>WEIGHT</u>	<u>VOLUME</u>
43.9 LBS	CU. IN.
	<u>Make</u>

STANDARD SYMBOLS	UNLESS OTHERWISE SPECIFIED:
 COUNTERBORE	DIMENSIONS ARE IN INCHES TOLERANCES: FRACTIONAL $\pm 1/32$ ANGULAR: MACH $1/2^\circ$ TWO DECIMAL $\pm .01$ THREE DECIMAL $\pm .005$ FOUR DECIMAL $\pm .0005$
 COUNTERSINK	
 CONCENTRICITY	
 TRUE POSITION	
 PERPENDICULARITY	
 CIRCULAR RUN OUT	
 TOTAL RUN OUT	
 HOLE DEPTH	
 SYMMETRIC	
 FLATNESS	
 ROUNDNESS	
 PARALLELISM	
 DIAMETER	
 "R" RADIUS	